

| Issue: | Drawn By: | Checked By: | CRF No.: | Date: | Description: |
|---------------|------------------|--------------------|-----------------|--------------|--|
| a | SJ | KB | 3609 | 21/10/25 | First Issue |
| b | DP | KB | 3671 | 26/02/26 | Added the L2H1 ID Buzz to vehicle list |
| c | | | | | |
| d | | | | | |

ID3KE

KammEdge.

Instructions

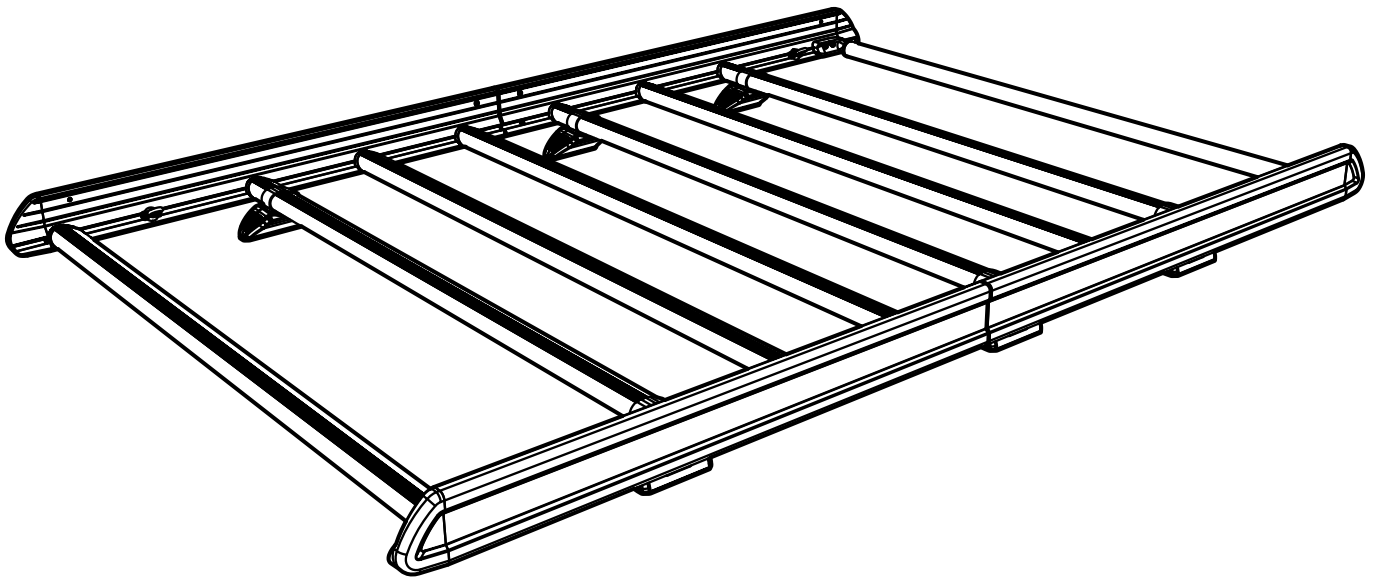

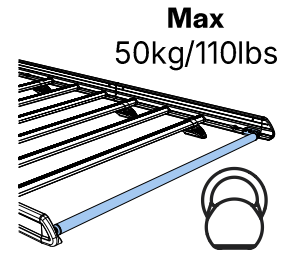
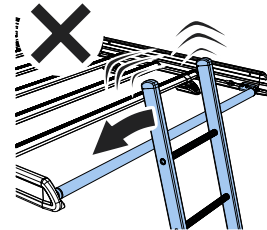
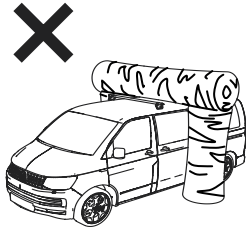
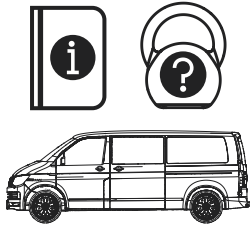

KammEdge.

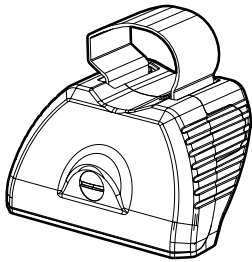

SA397U x 3

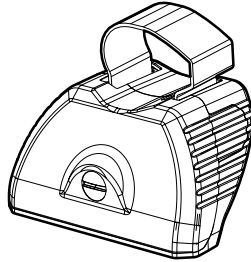

SA398U x 3

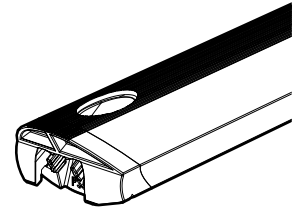

SA428/SA466 x 7

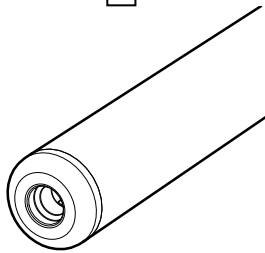

SA436 x 1

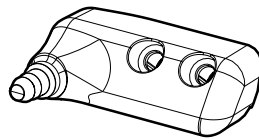

PS519 x 1

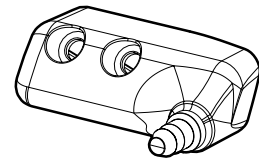

PS520 x 1

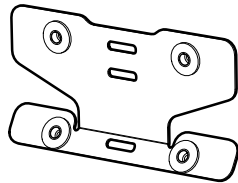

SA610 x 2

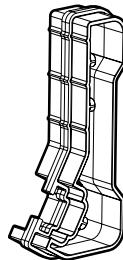

PS635 x 2

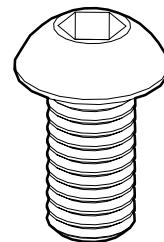

**FS323
(M6 x 16) x 8**

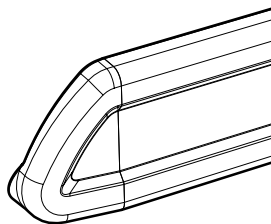

LSF (L) x 2

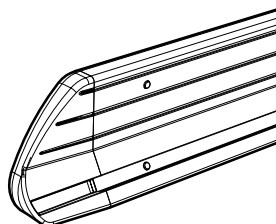

LSF (R) x 2



C04 x 6
optional upgrade

Fitting Kit

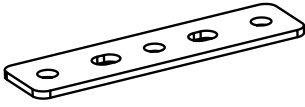

PS023 x 6

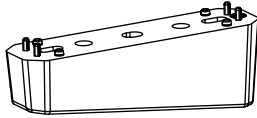

PS175 x 2

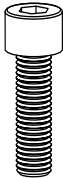

**FS059
(M8 x 25) x 18**

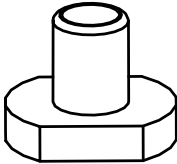

FN085 x 18

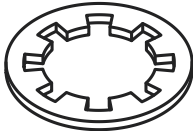

FW009 (M8) x 6

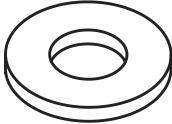

FW002 (M8) x 6

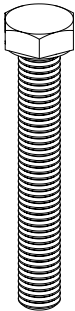

**FS091
(M8 x 60) x 2**

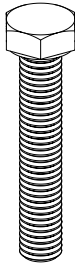

**FS015
(M8 x 25) x 4**



FT05 x 1



FT01 x 1



1.

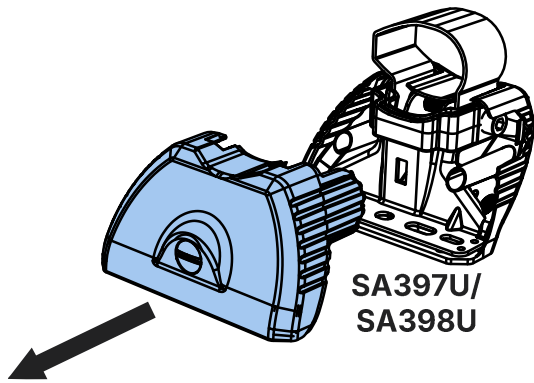

2.

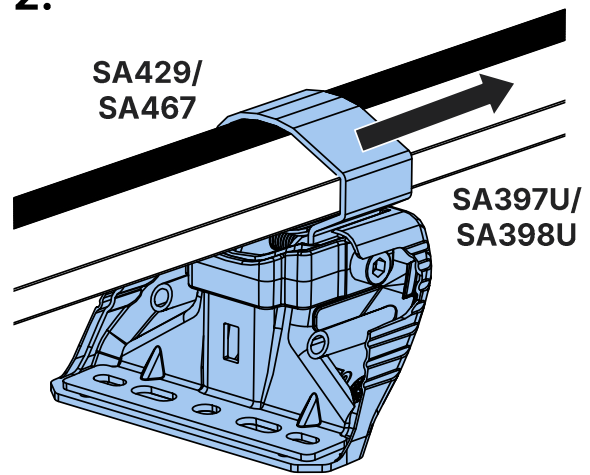

3.

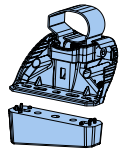

SA397U
PS175

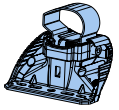

SA397U

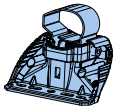

SA397U

R

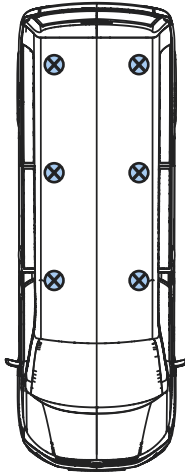

F

SA398U
PS175

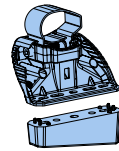

SA398U

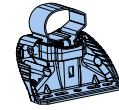

SA398U

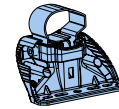

4.

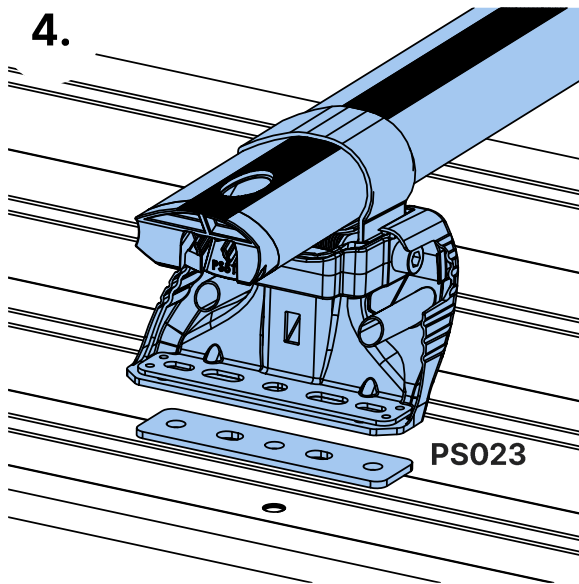

5.

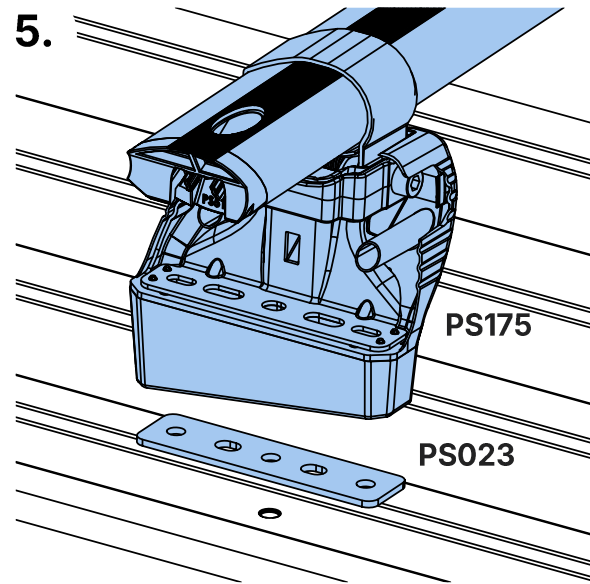

6.

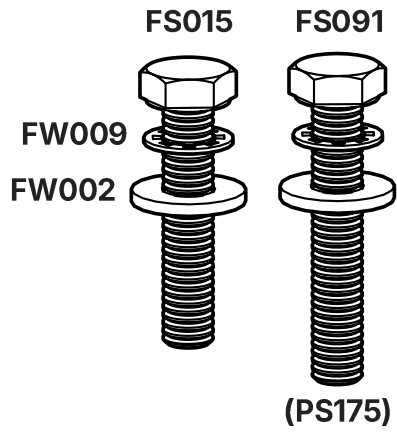

7.

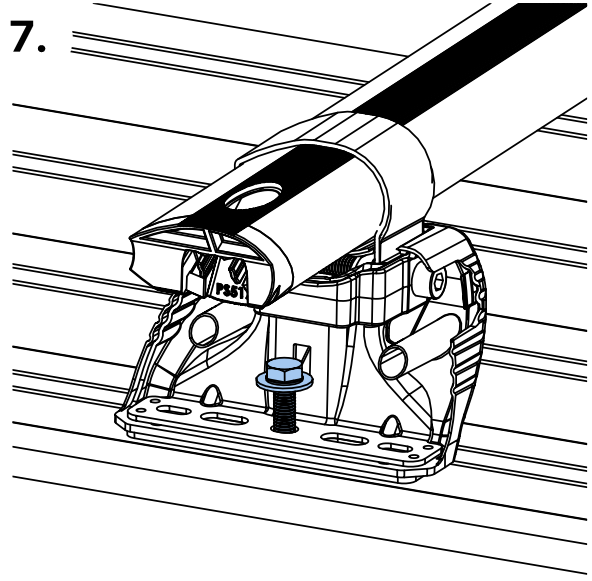

8.

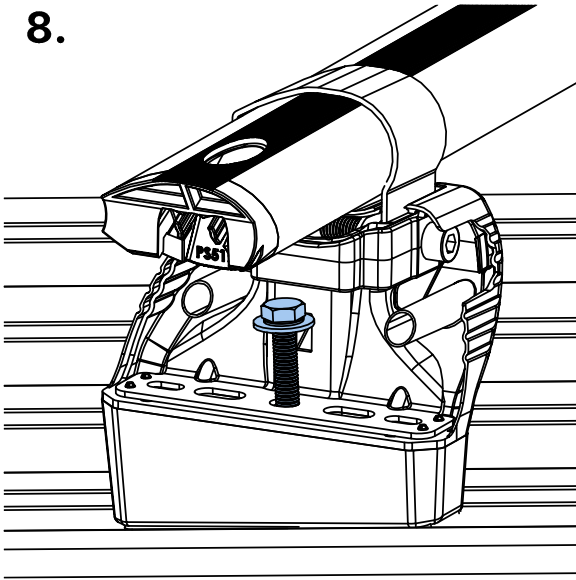

9.

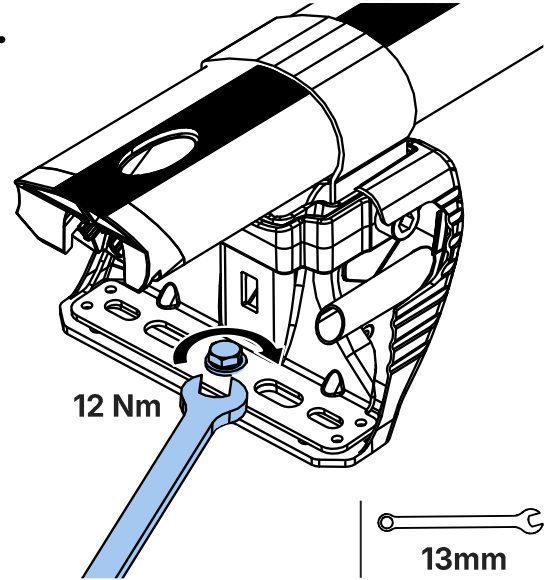

10.

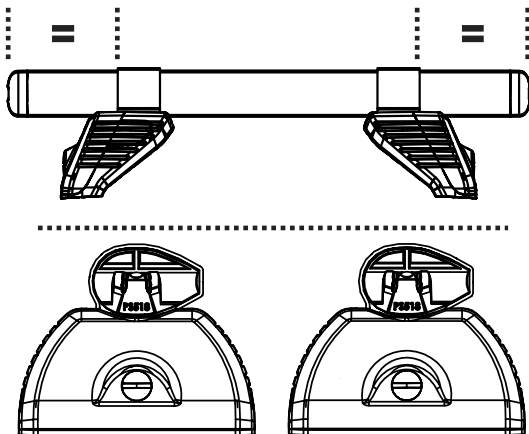

11.

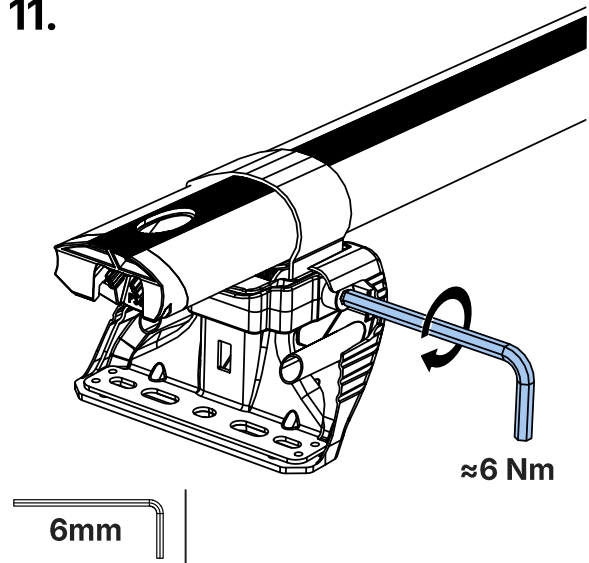

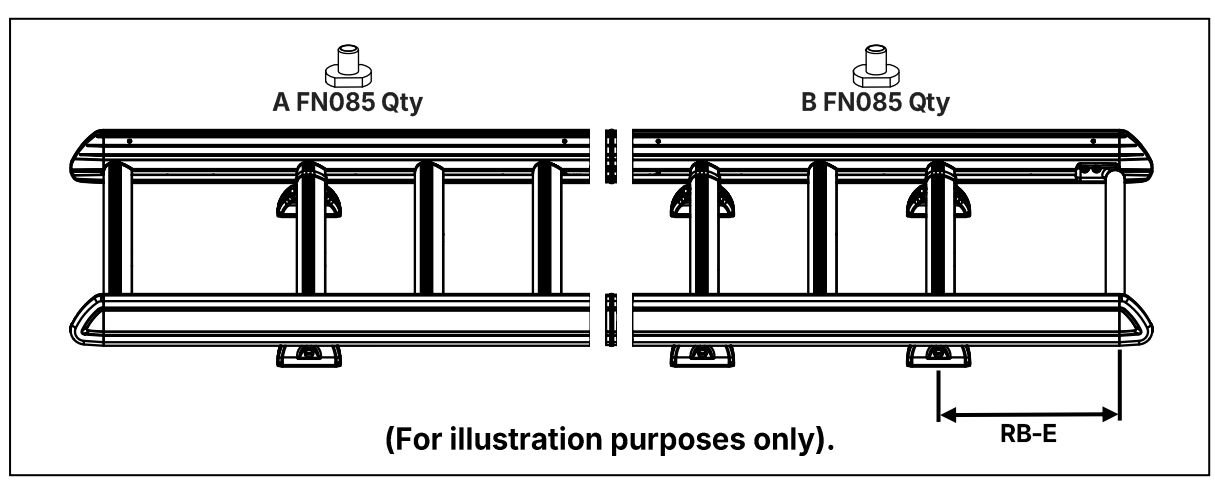
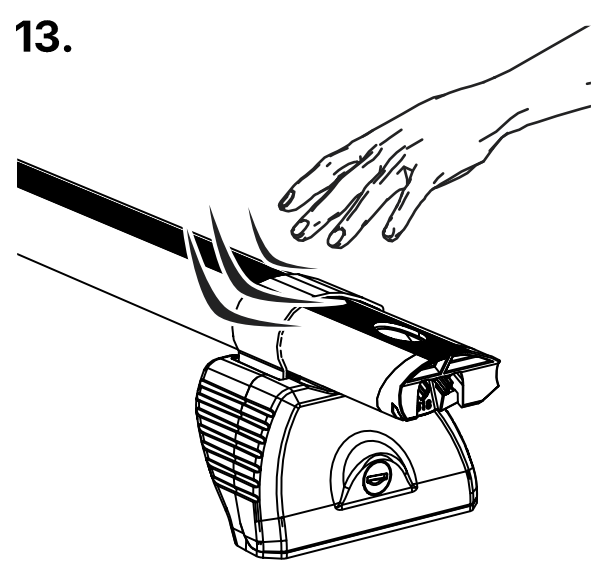
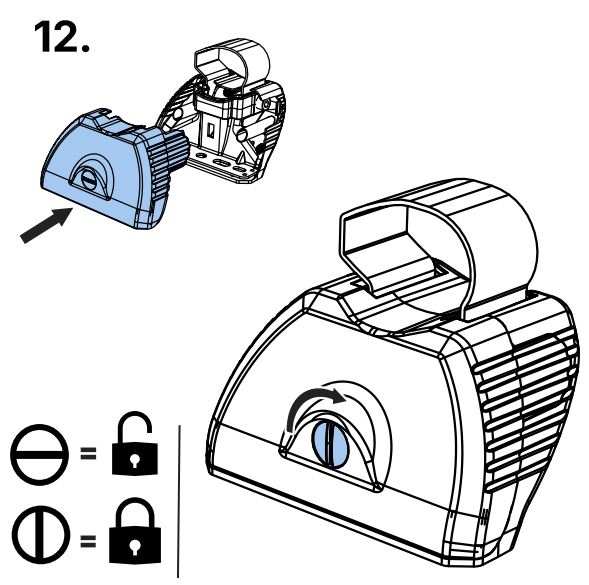

| L688/LB688- ID Buzz 2022-, L1-H1 (Tailgate) | | |
|---|--------------------|----------------------------|
| <p>Max Load = 150kg/330lbs</p> <p>L688/LB688 = 22kg/48lbs</p> | | |
| A FN085 Qty | B FN085 Qty | Rear Bar – End (mm) |
| 3 | 6 | 130 |

L689/LB689- ID Buzz 2022-, L1-H1 (Twin)

Max Load = 150kg/330lbs

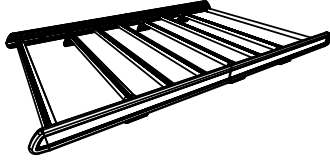

L689/LB689 = 22kg/48lbs

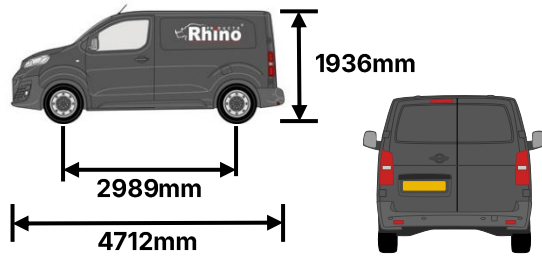

| A FN085 Qty | B FN085 Qty | Rear Bar – End (mm) |
|-------------|-------------|---------------------|
| 3 | 6 | 500 |

L689/LB689- ID Buzz 2022-, L2-H1 (Tailgate)

Max Load = 150kg/330lbs

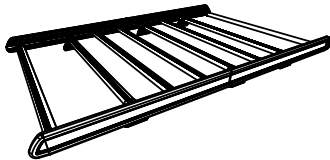

L689/LB689 = 22kg/48lbs

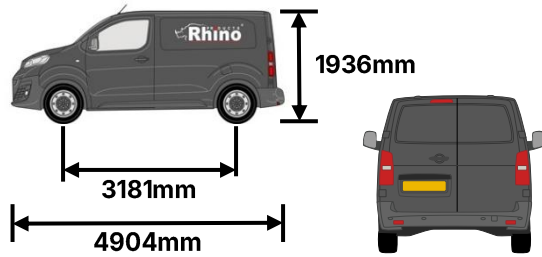

| A FN085 Qty | B FN085 Qty | Rear Bar – End (mm) |
|-------------|-------------|---------------------|
| 3 | 6 | 130 |

L701/LB701- ID Buzz 2022-, L2-H1 (Twin)

Max Load = 150kg/330lbs

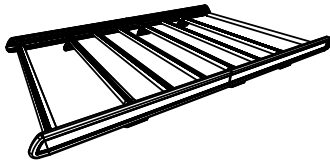

L689/LB689 = 22kg/48lbs

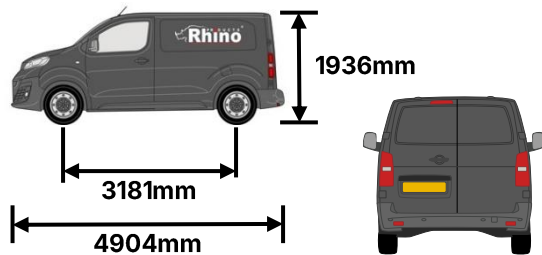

| A FN085 Qty | B FN085 Qty | Rear Bar – End (mm) |
|-------------|-------------|---------------------|
| 3 | 6 | 500 |

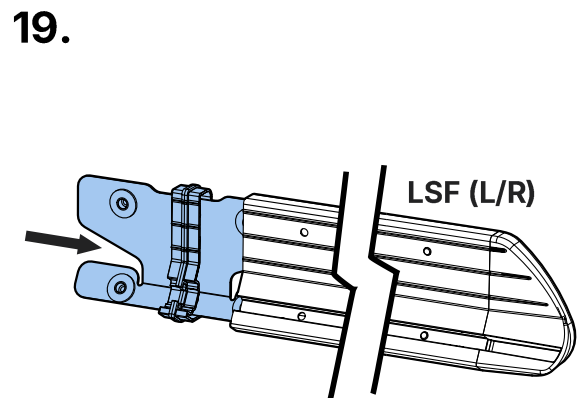
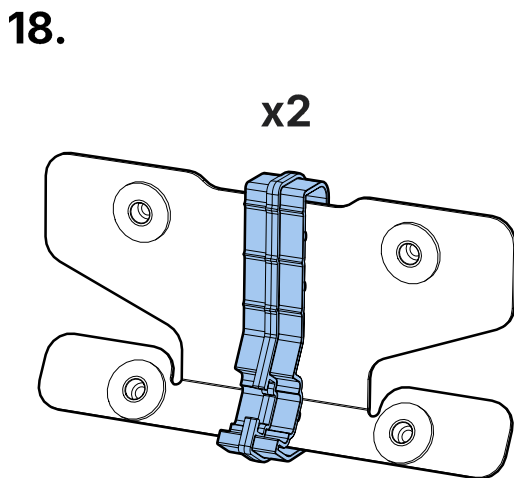
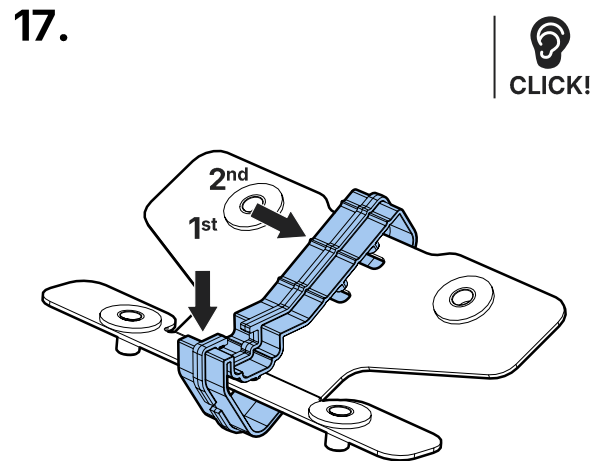
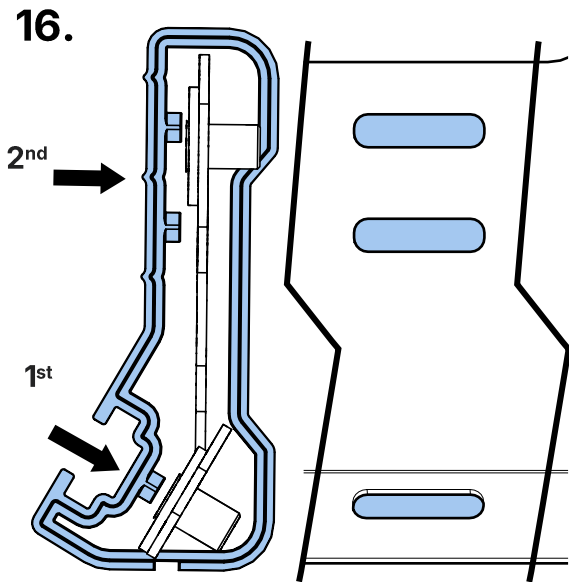
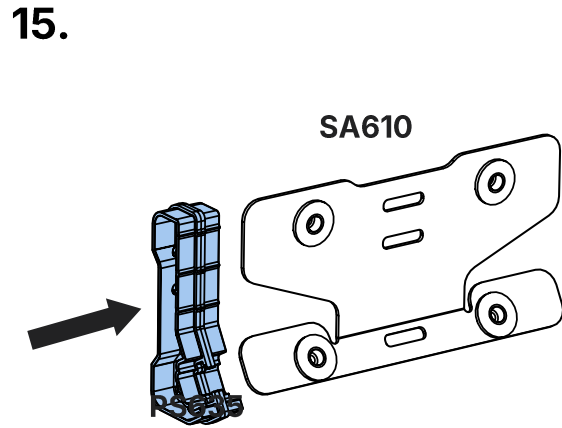
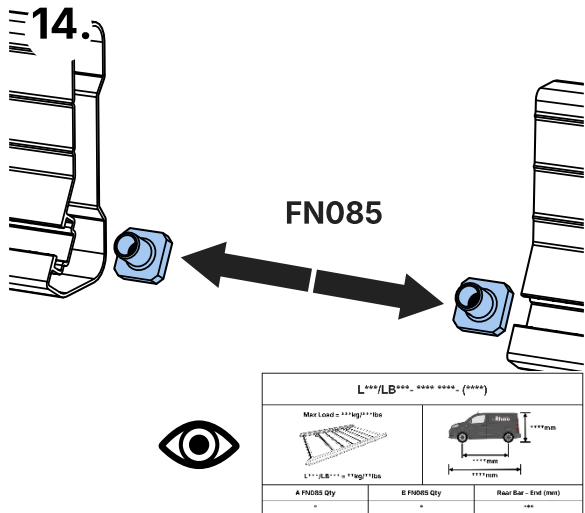

20.

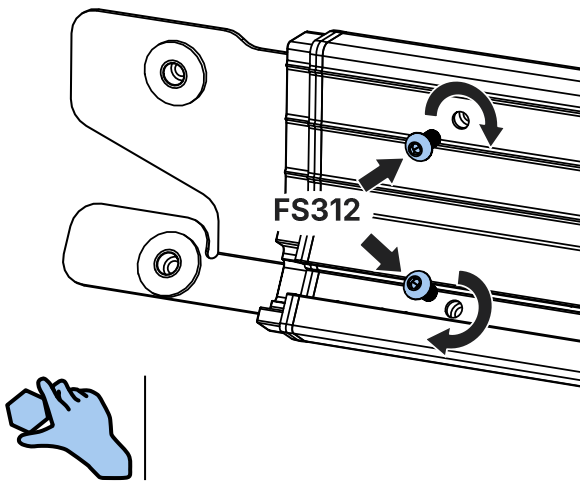

21.

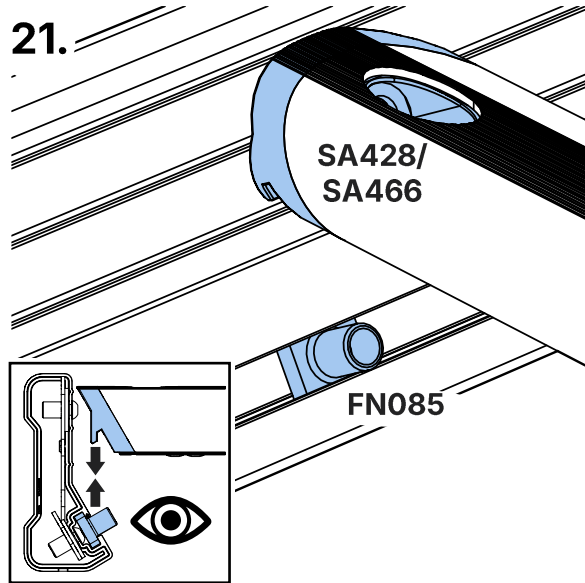

22.

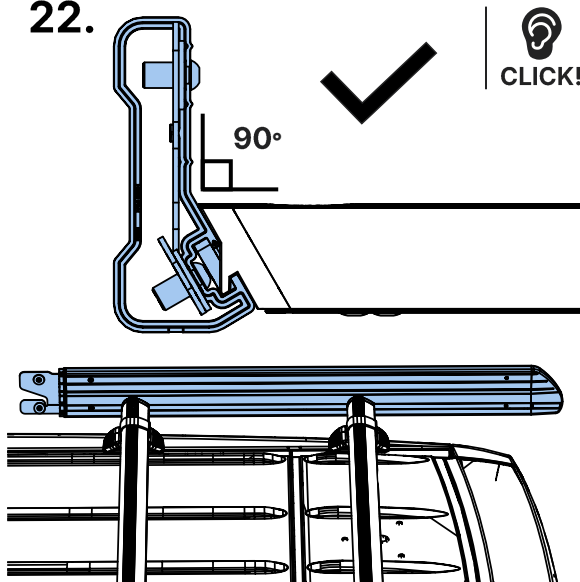

23.

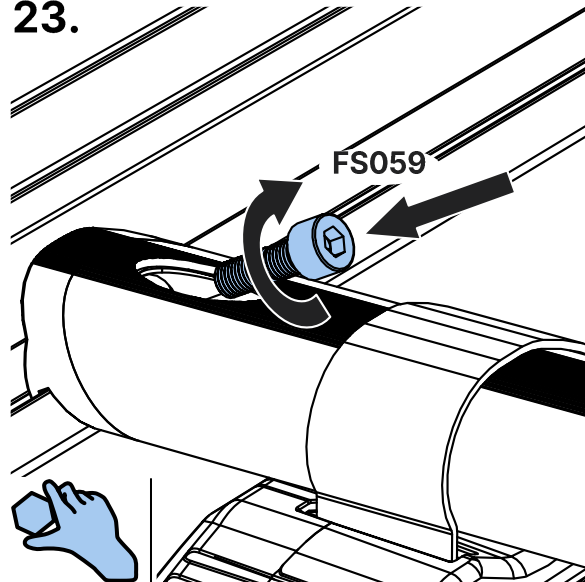

24.

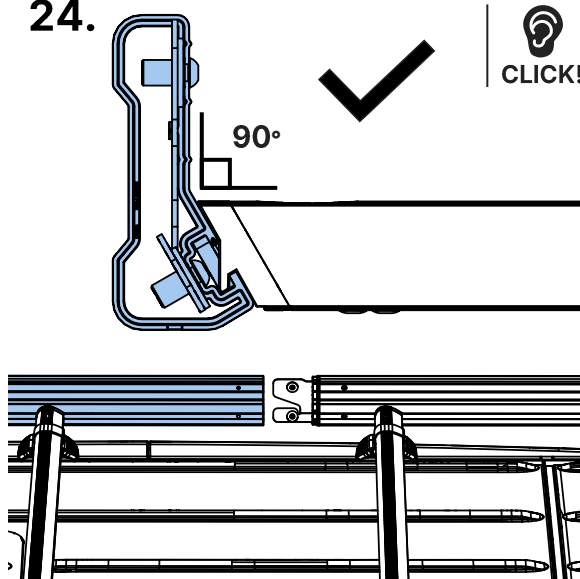

25.

