

Issue:	Drawn By:	Checked By:	CRF No.:	Date:	Description:
a	SJ	KB	3609	21/10/25	First Issue
b					
c					
d					

KA3KE

KammEdge.

Instructions

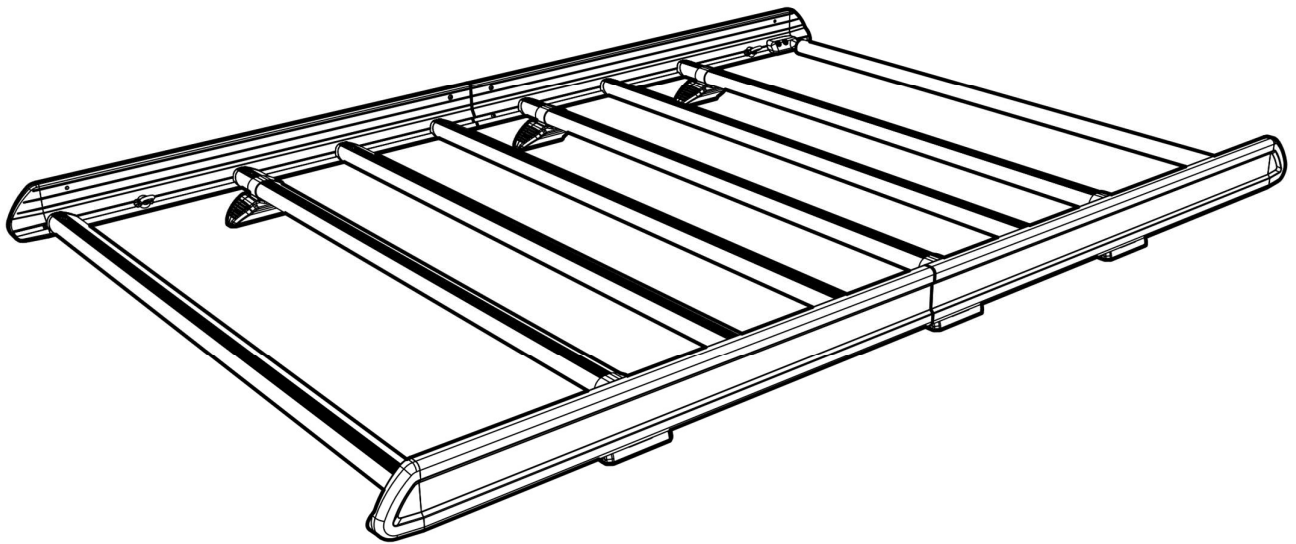

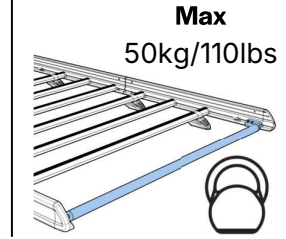
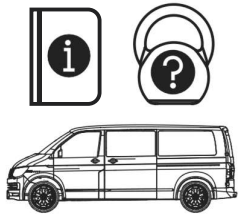

KammEdge.

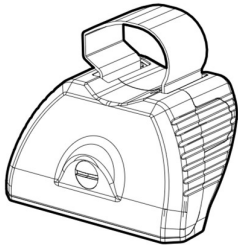

SA397U x 3

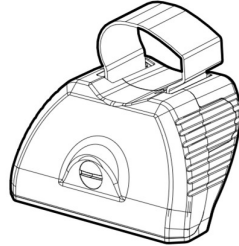

SA398U x 3



SA428/SA466 x 5



SA436 x 1

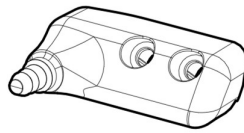

PS519 x 1

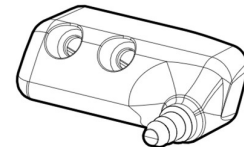

PS520 x 1

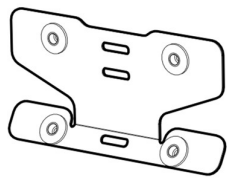

SA610 x 2



PS635 x 2

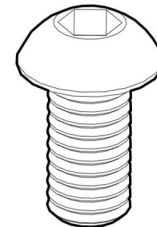

**FS323
(M6 x 16) x 8**

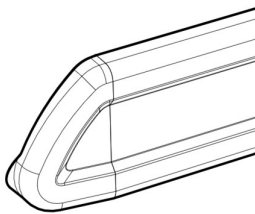

LSF (L) x 2

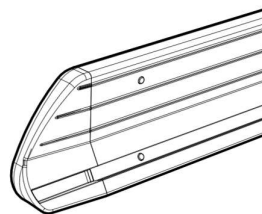

LSF (R) x 2



C04 x 6
optional upgrade

Fitting Kit

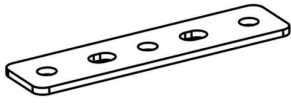

PS023 x 6

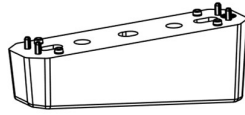

PS176 x 4



FS059
(M8 x 25) x 14

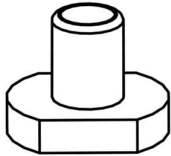

FN085 x 14

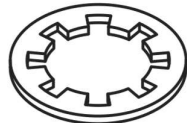

FW009 (M8) x 6

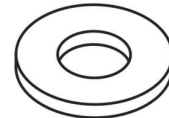

FW002 (M8) x 6

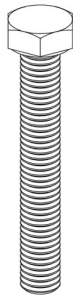

FS081
(M8 x 50) x 4

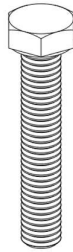

FS062
(M8 x 25) x 2

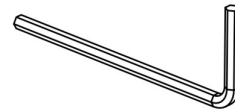

FT05 x 1



FT01 x 1

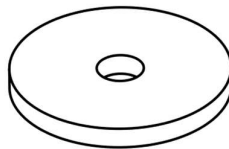

PS260 (M8) x 6



1.



2.

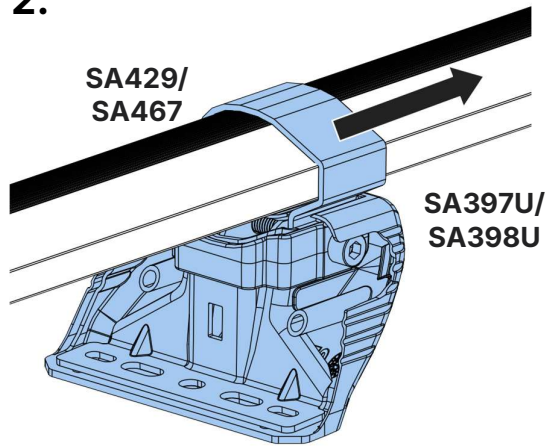

3.



SA397U
PS176



SA397U

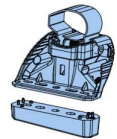

SA397U
PS176

R

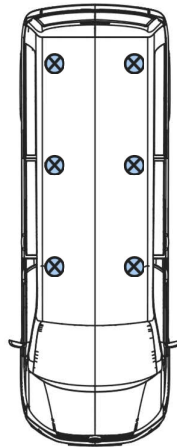

F

SA398U
PS176

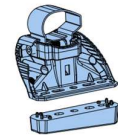

SA398U



SA398U
PS176

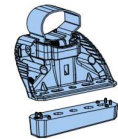

4.

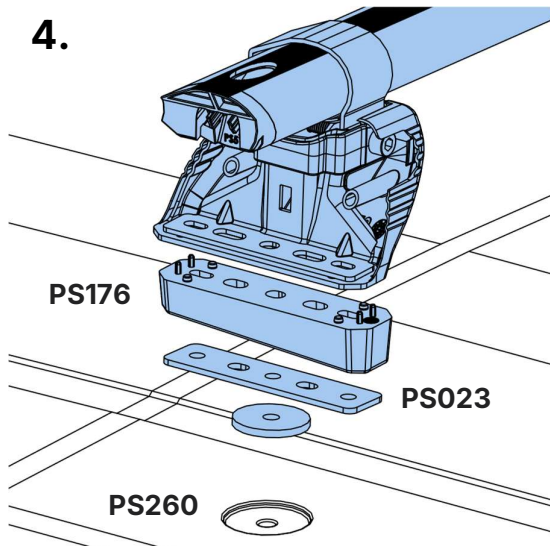

5.

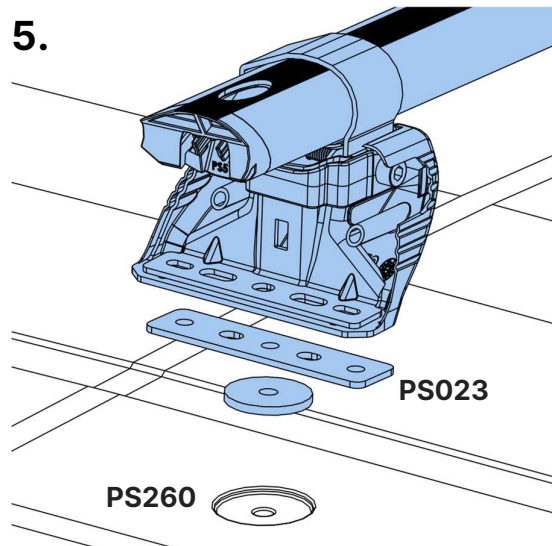

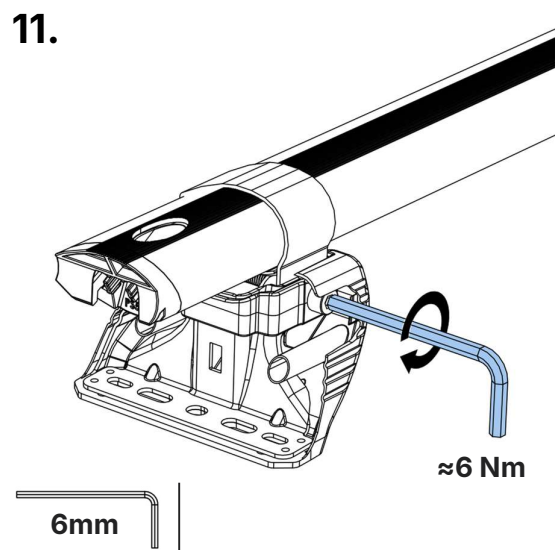
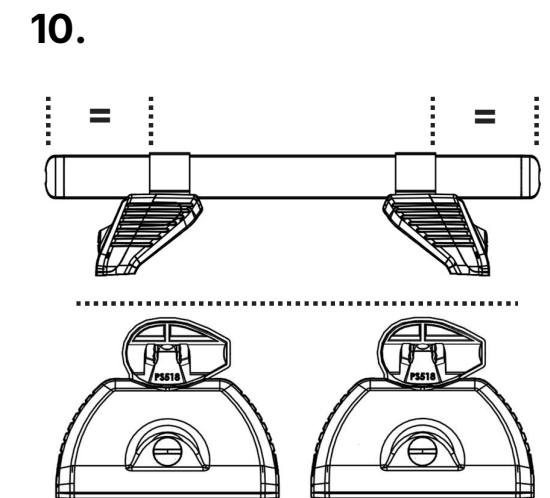
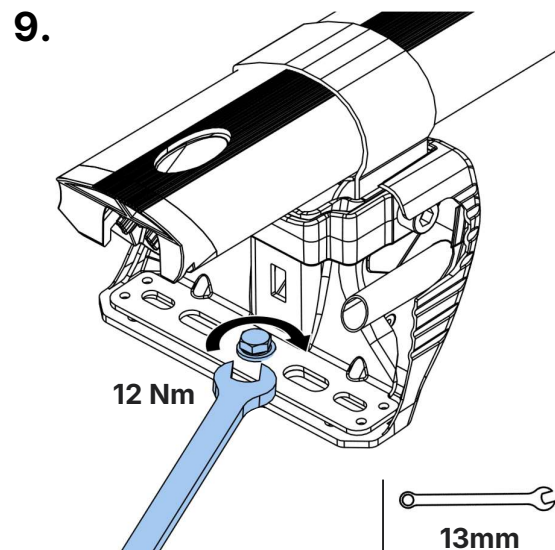
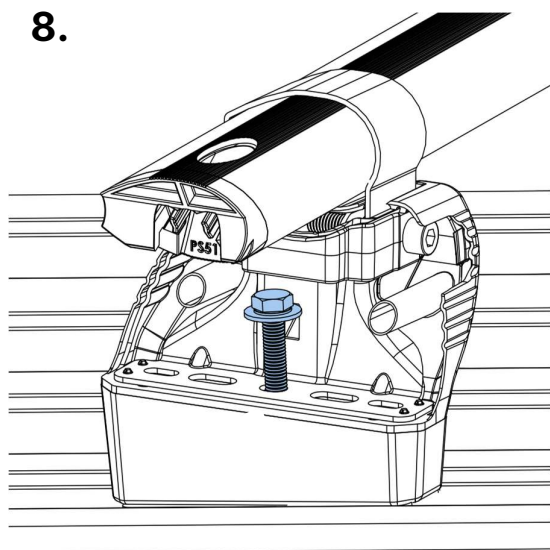
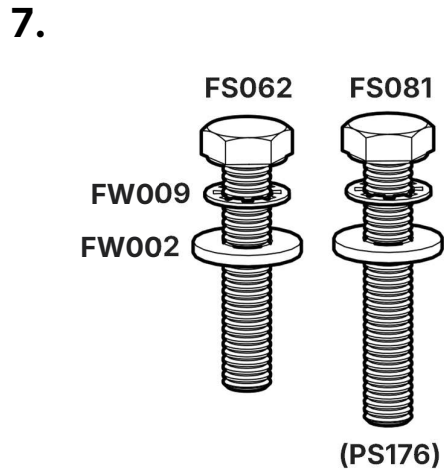
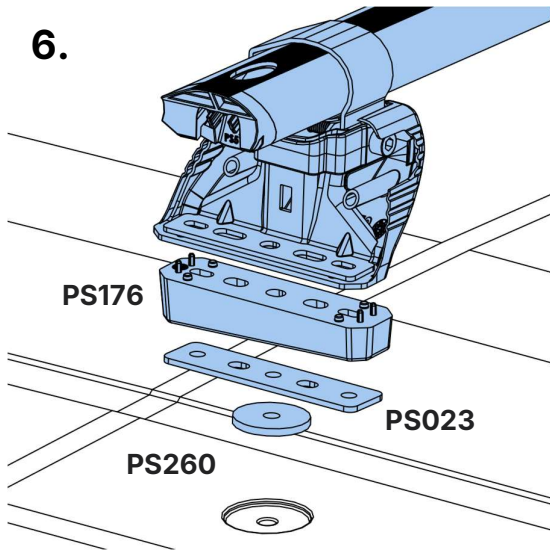

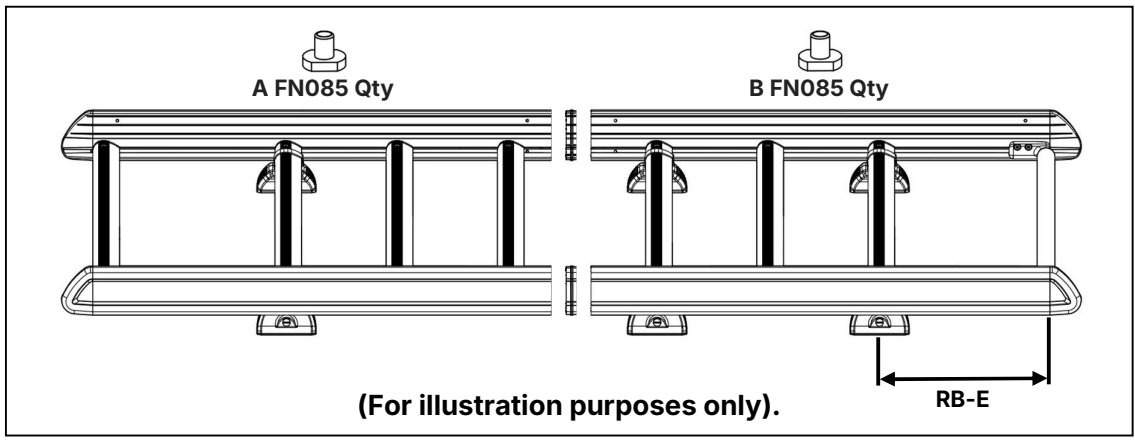
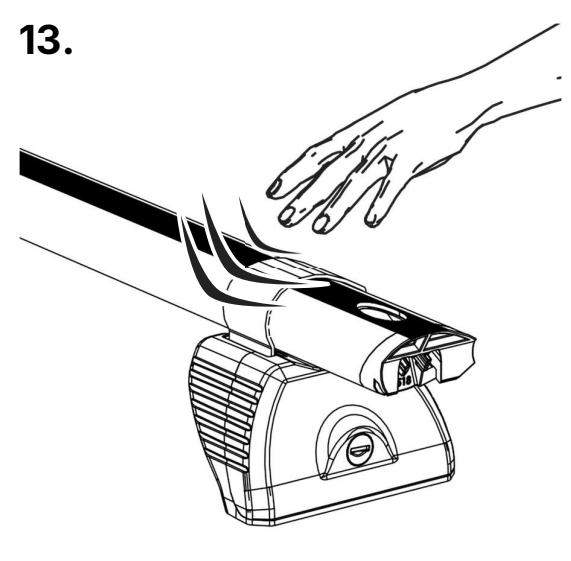
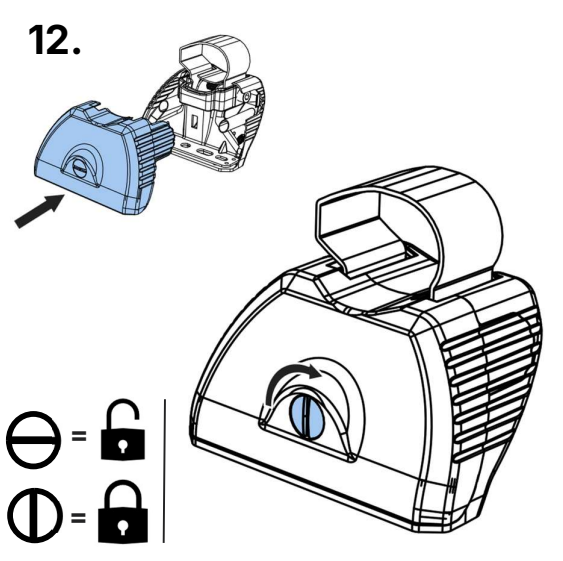

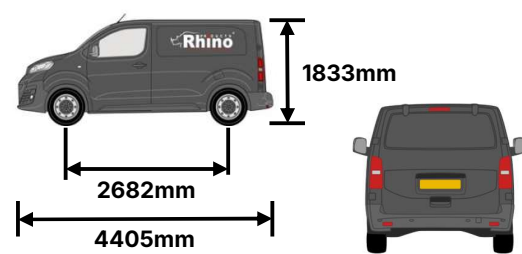
L608/LB608- Caddy 2010-2015, L1-H1 (Twin)		
<p>Max Load = 150kg/330lbs</p>  <p>L608/LB608 = 19kg/42lbs</p>		
A FN085 Qty	B FN085 Qty	Rear Bar – End (mm)
3	4	265

L609/LB609- Caddy 2010-2015, L1-H1 (Tailgate)

Max Load = 150kg/330lbs



L609/LB609 = 18kg/40lbs

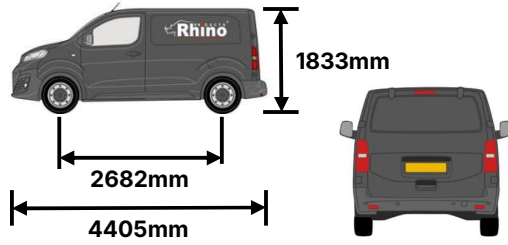

A FN085 Qty

B FN085 Qty

Rear Bar – End (mm)

3

4

90

L609/LB609- Caddy 2015-2020, L1-H1 (Tailgate)

Max Load = 150kg/330lbs



L609/LB609 = 18kg/40lbs

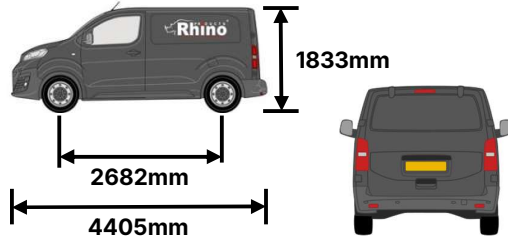

A FN085 Qty

B FN085 Qty

Rear Bar – End (mm)

3

4

105

20.

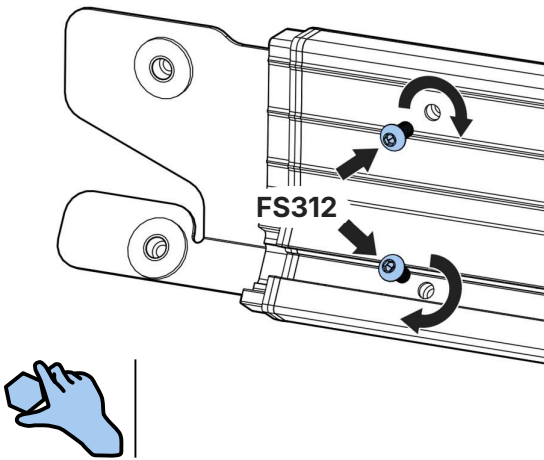

21.

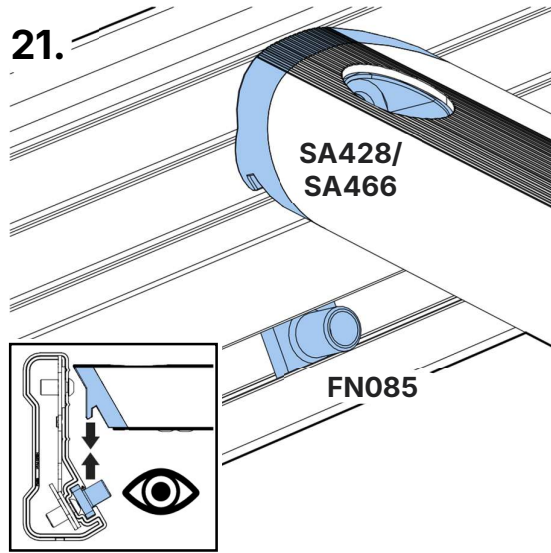

22.

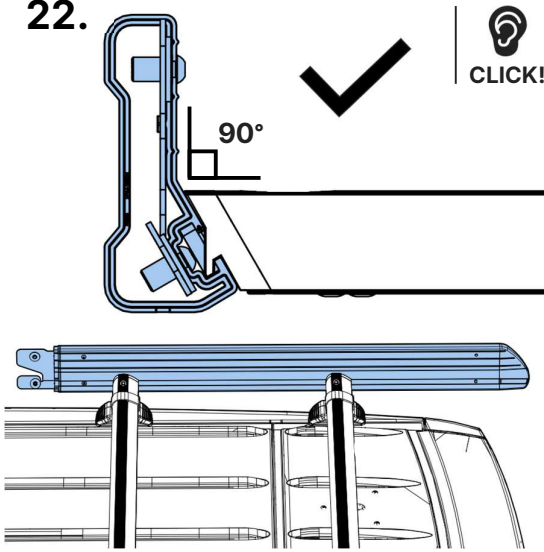

23.

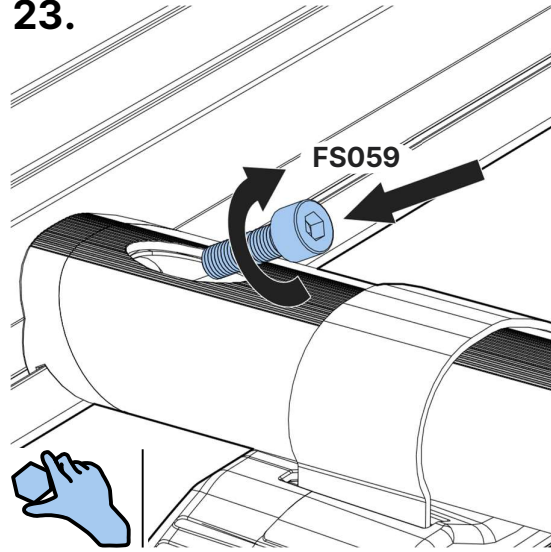

24.

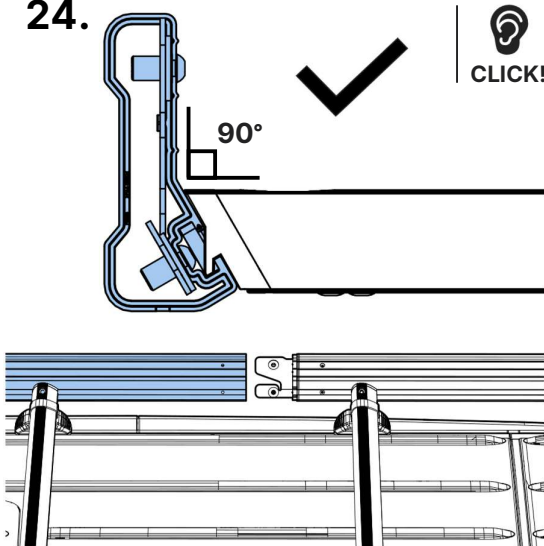

25.

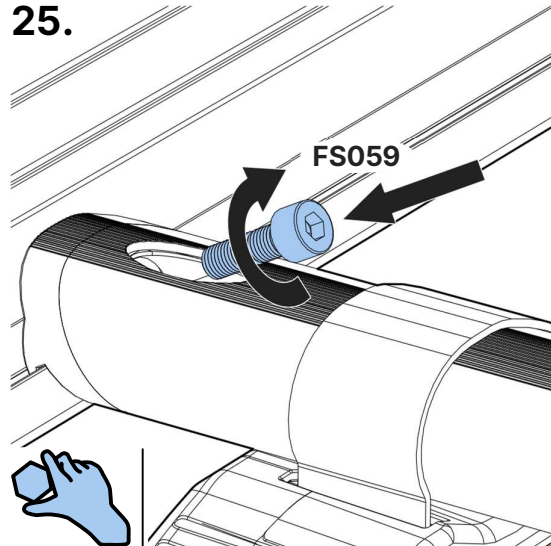

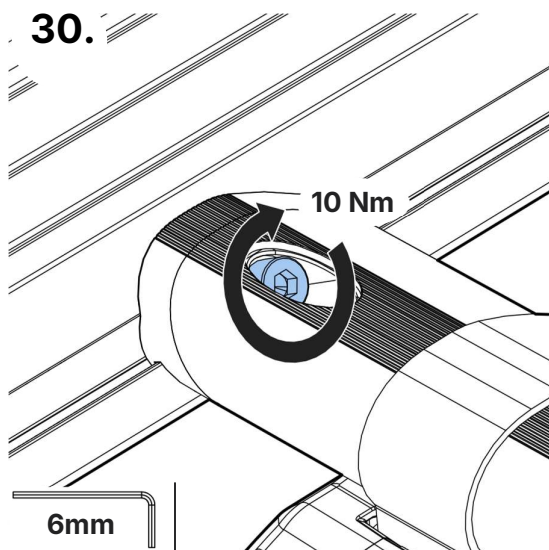
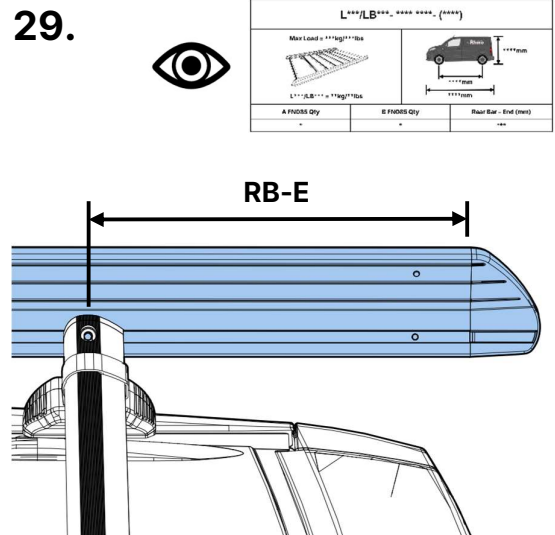
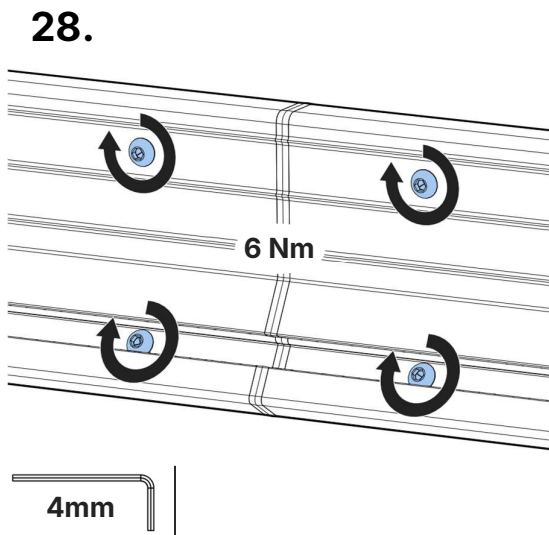
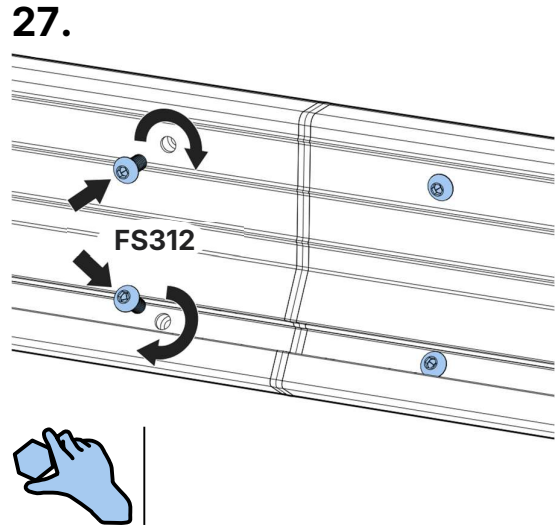
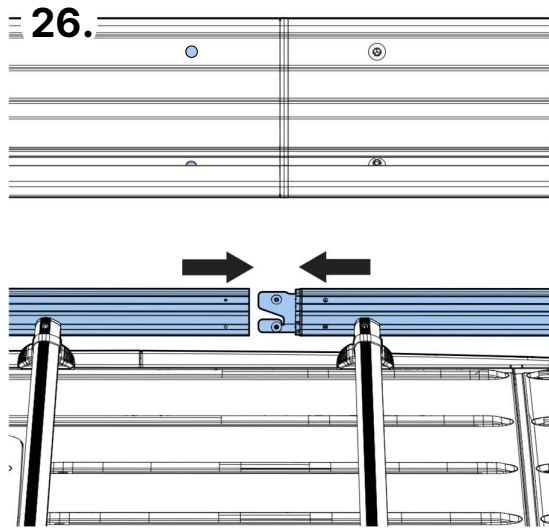

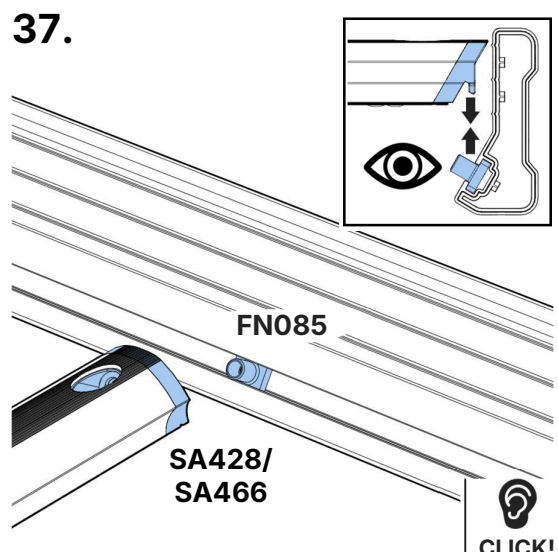
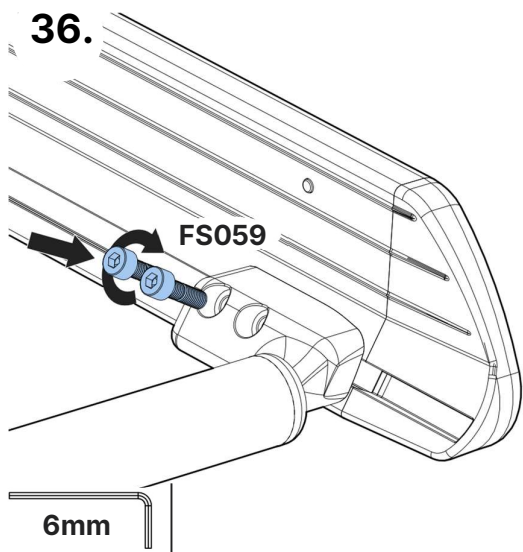
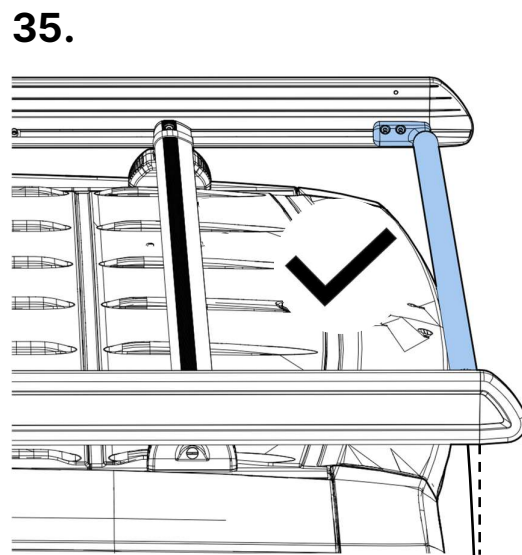
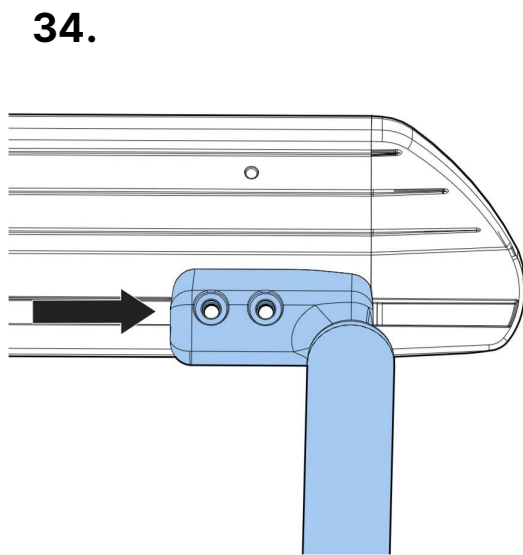
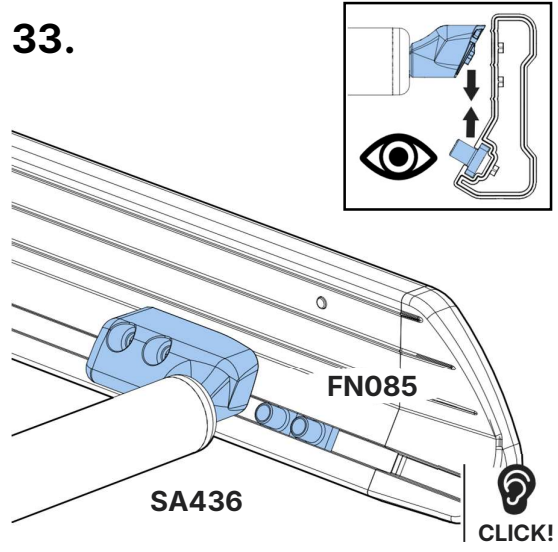
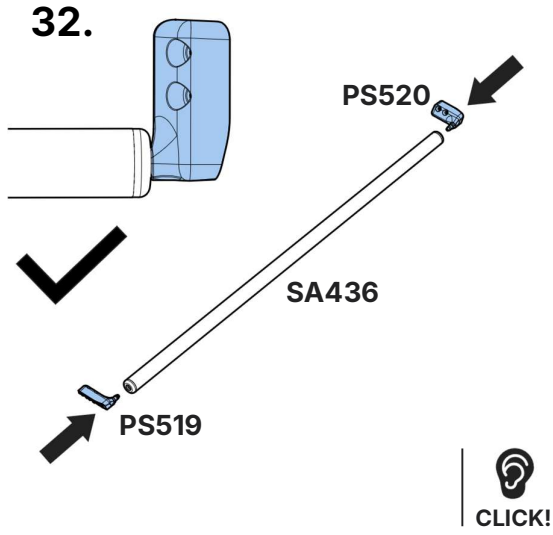

38.

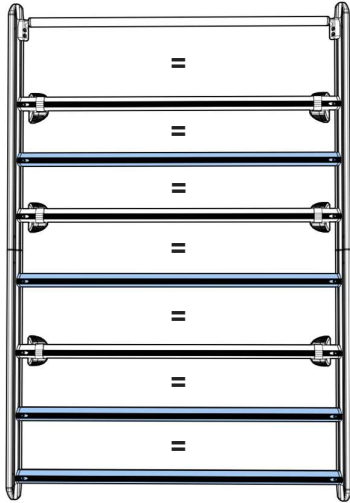

39.

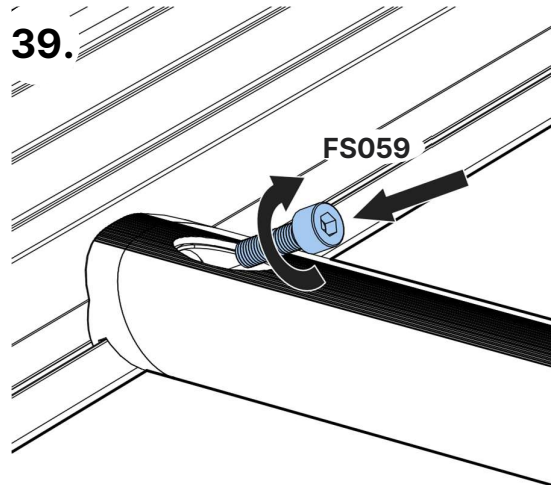

40.

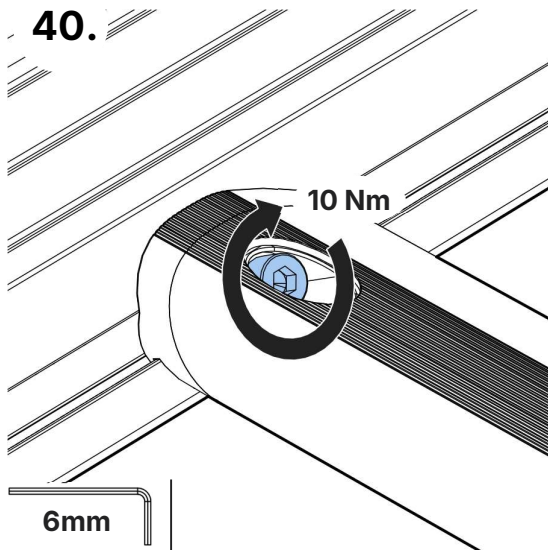

41.

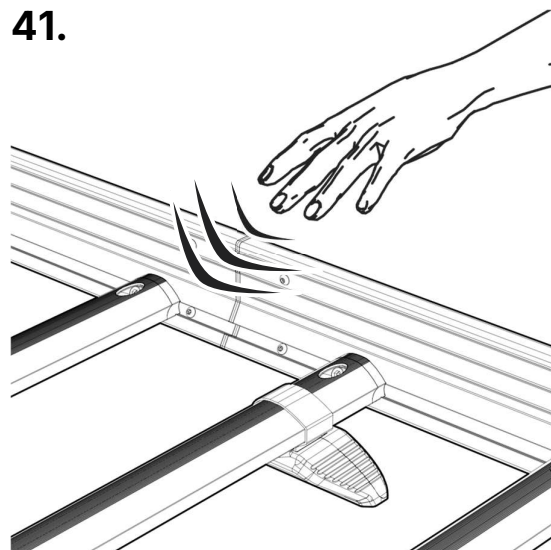

42.

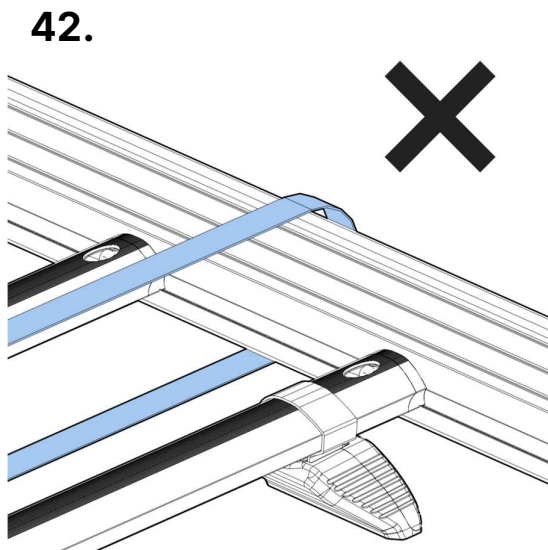

43.

