

Issue:	Drawn By:	Checked By:	CRF No.:	Date:	Description:
a	SJ	KB	3609	21/10/25	First Issue
b					
c					
d					

MC3KE

KammEdge.

Instructions

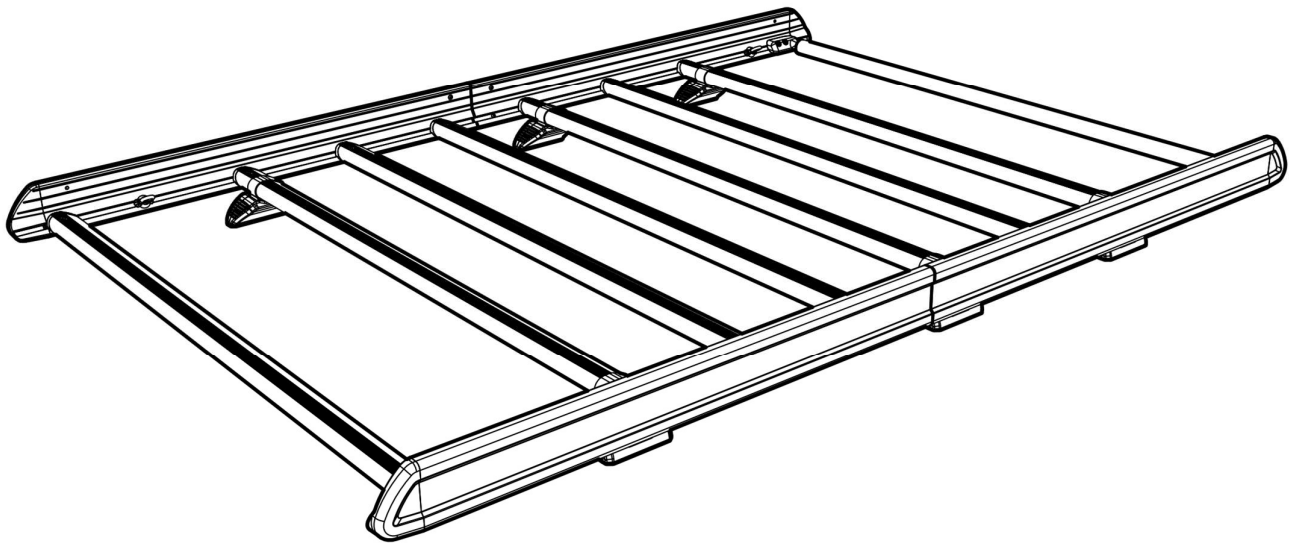

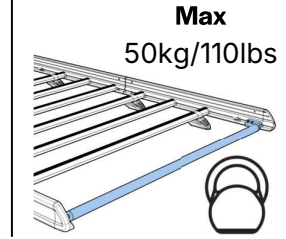
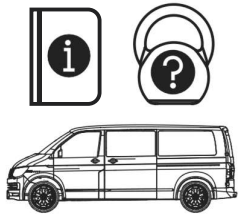

KammEdge.

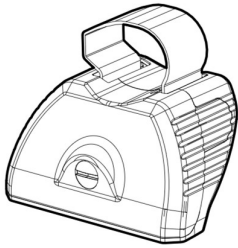

SA397U x 3

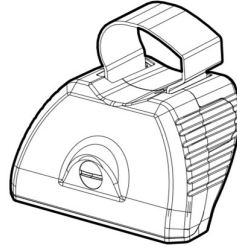

SA398U x 3



SA430/SA468 x 8



SA438 x 1

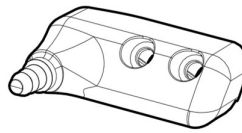

PS519 x 1

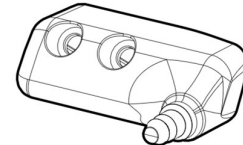

PS520 x 1

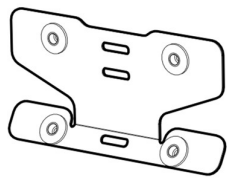

SA610 x 2



PS635 x 2

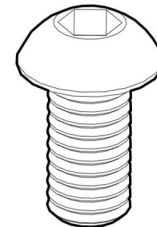

**FS323
(M6 x 16) x 8**

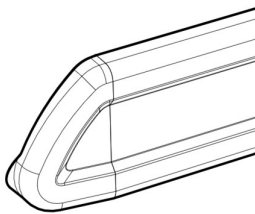

LSF (L) x 2

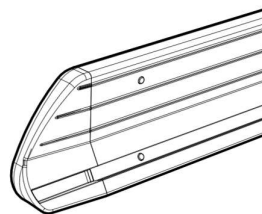

LSF (R) x 2



**C04 x 6
*optional upgrade***

Fitting Kit

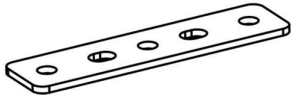

PS023 x 6

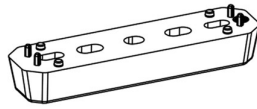

PS183 x 6

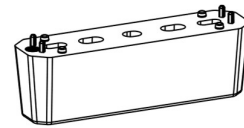

PS325 x 6

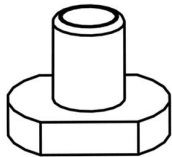

FN085 x 20



FN006 (M8) x 12

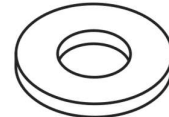

FW002 (M8) x 12



FS107
(M8 x 75) x 6



FS081
(M8 x 50) x 6

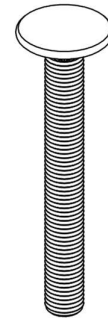

FS293
(M8 x 65) x 12



FT01 x 1



FT05 x 1

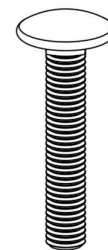

FS134
(M8 x 45) x 12

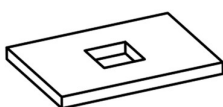

MS209 x 12



FS059
(M8 x 25) x 20



PS020 x 6



1.



2.

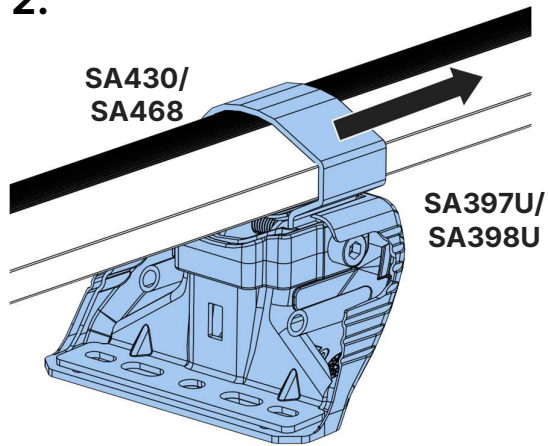

3a.

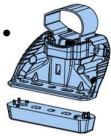

SA397U
PS183/PS325



SA397U
PS183/PS325



SA397U
PS183/PS325

R

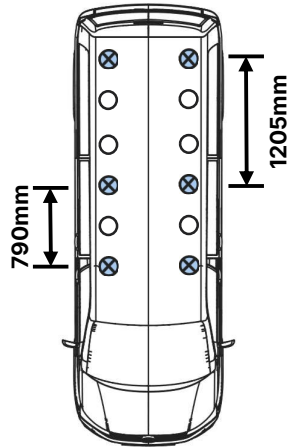

SA398U
PS183/PS325

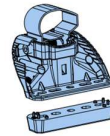

SA398U
PS183/PS325



SA398U
PS183/PS325



! SPRINTER/CRAFTER,
L1-H1, 2006-

F

3b.

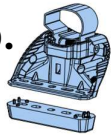

SA397U
PS183/PS325



SA397U
PS183/PS325



SA397U
PS183/PS325

R

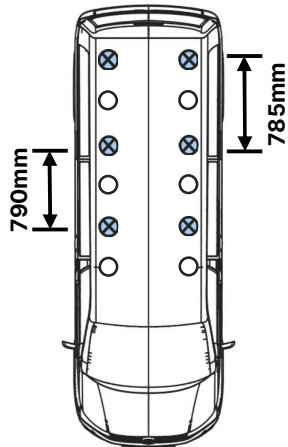

SA398U
PS183/PS325

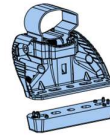

SA398U
PS183/PS325

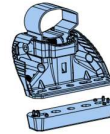

SA398U
PS183/PS325

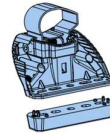

! SPRINTER/CRAFTER,
L1-H2, 2006-

F

4.

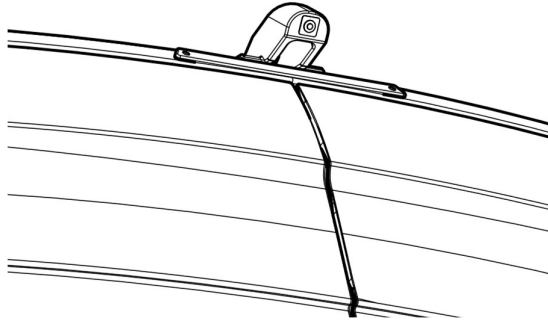
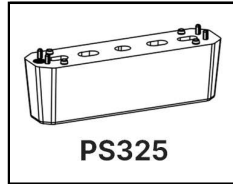

5.

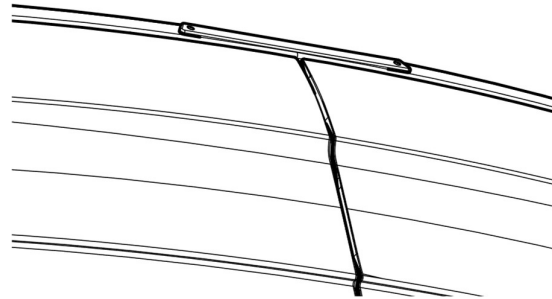
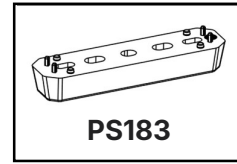

6a.

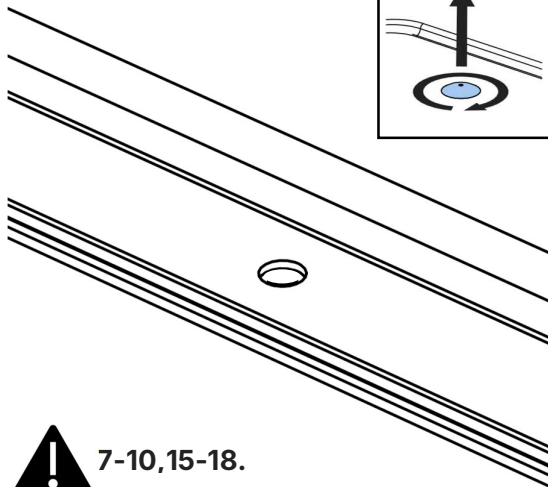
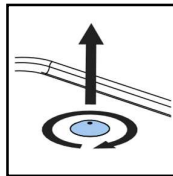

 7-10,15-18.

6b.

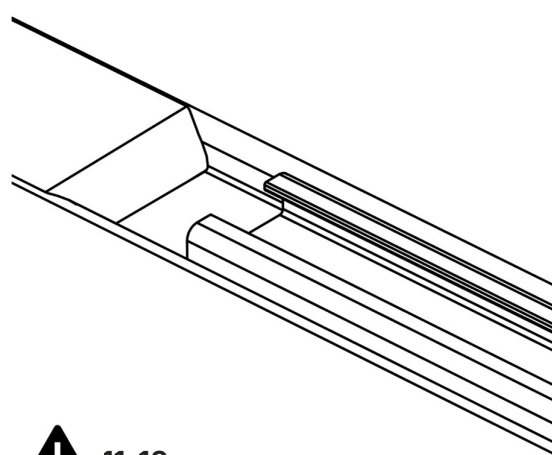

 11-18.

7.

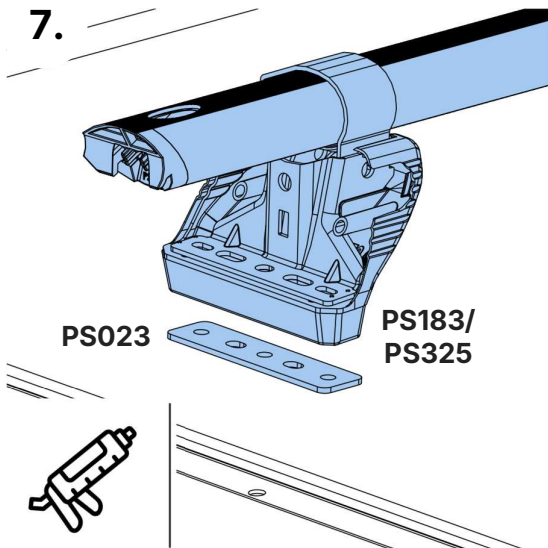

8.

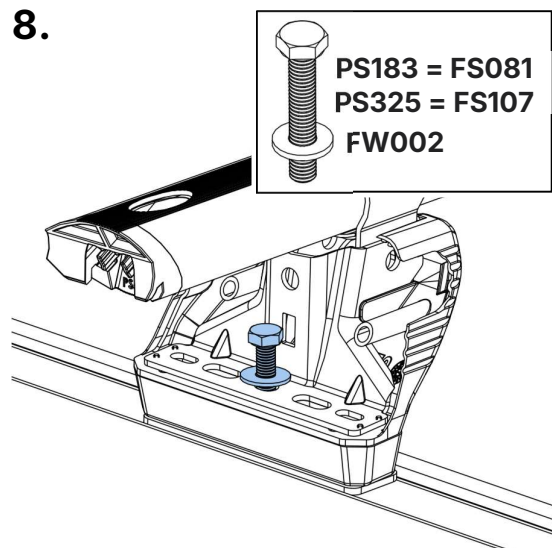

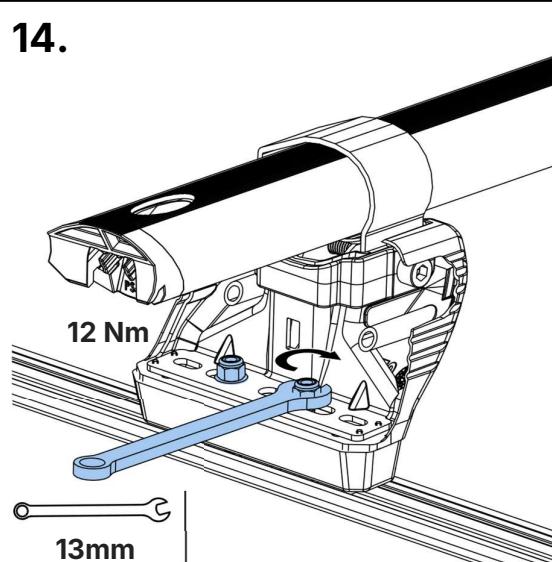
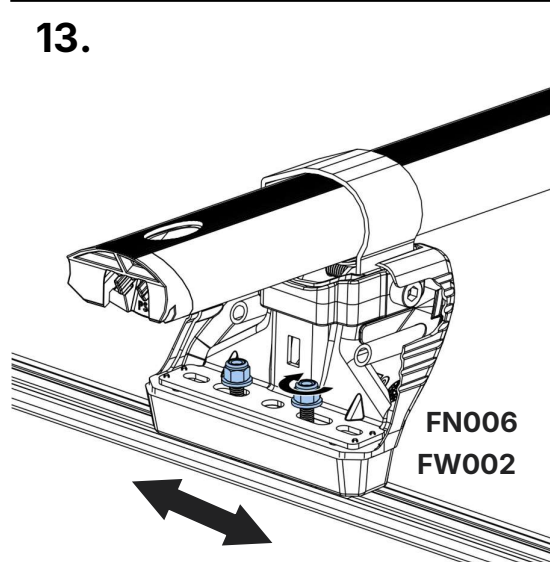
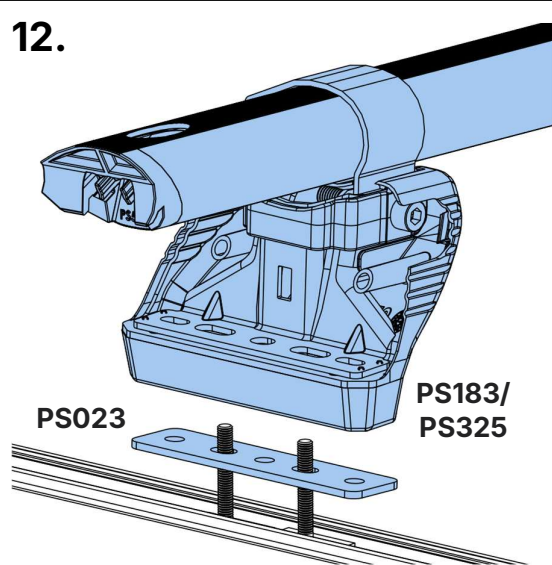
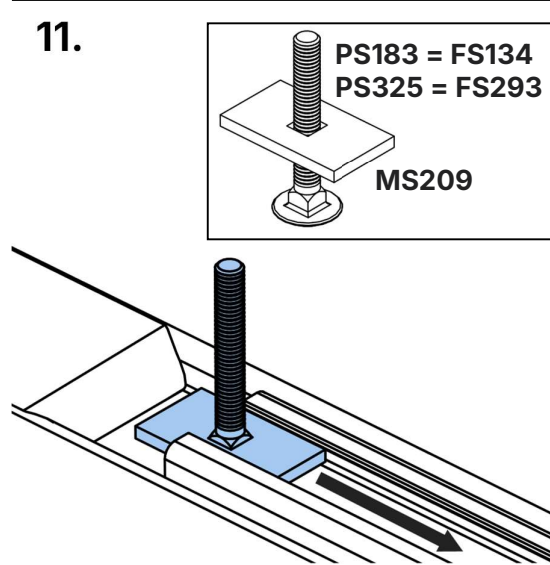
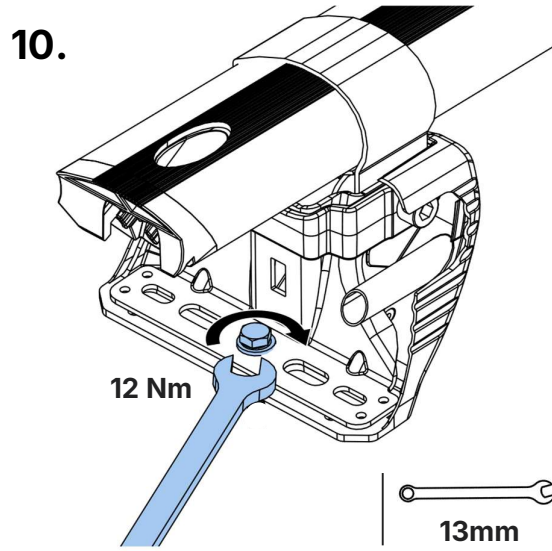
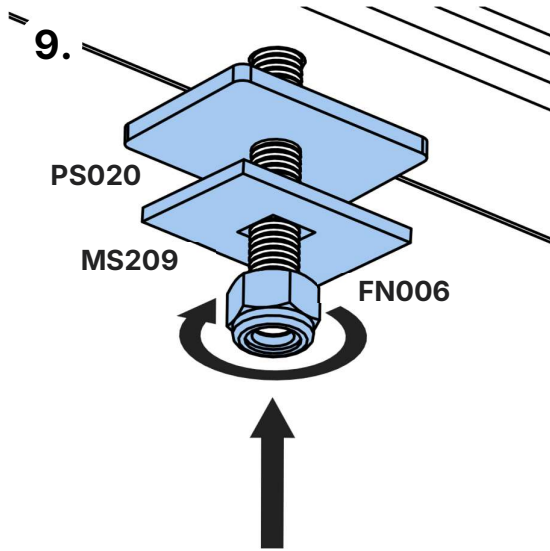

15.

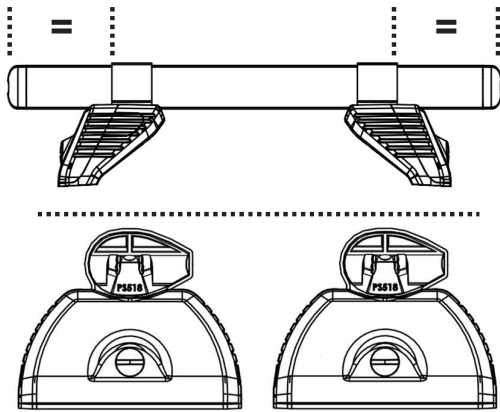

16.

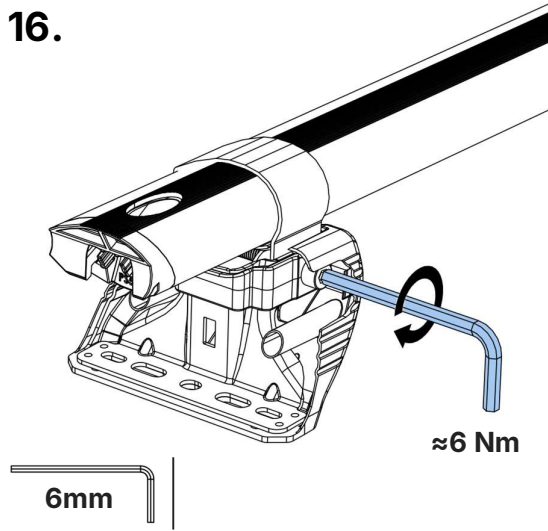

17.

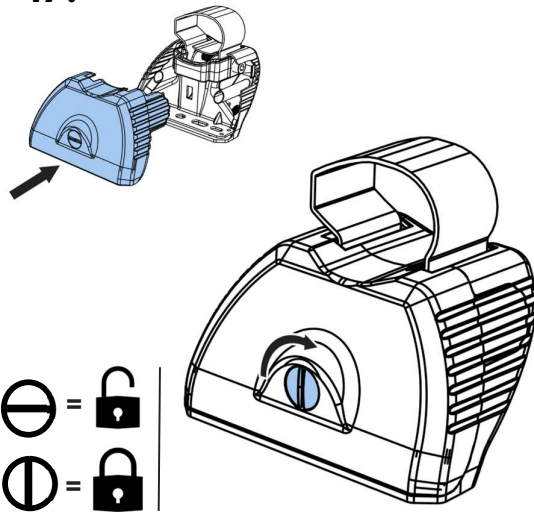

18.

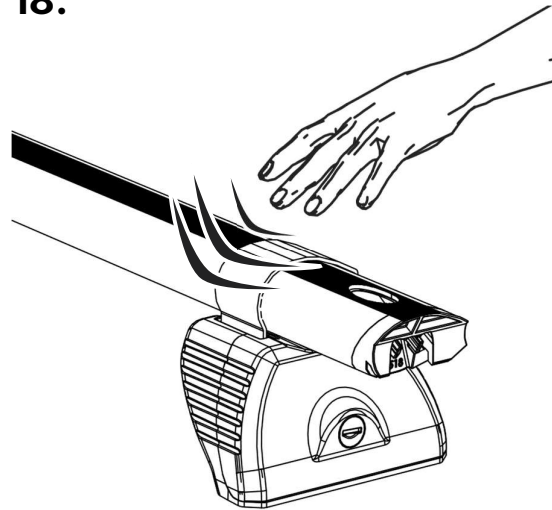

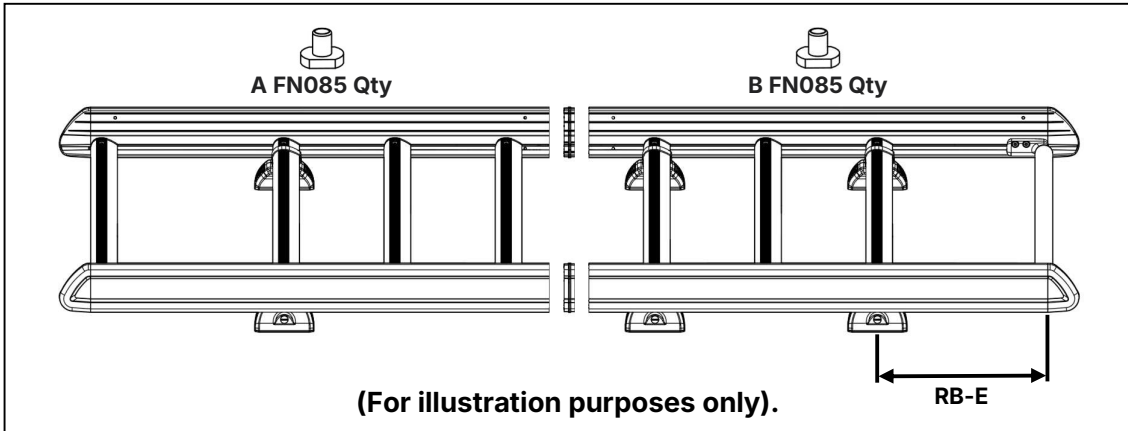

L517/LB517- Sprinter/Crafter 2006-, L1-H1 (Twin)

Max Load = 150kg/330lbs



L517/LB517 = 29kg/64lbs

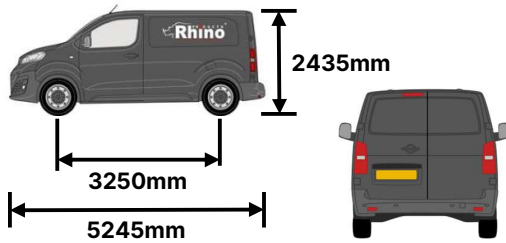

A FN085 Qty	B FN085 Qty	Rear Bar – End (mm)
4	6	490

L518/LB518- Sprinter/Crafter 2006-, L1-H2 (Twin)

Max Load = 150kg/330lbs



L518/LB518 = 28kg/62lbs

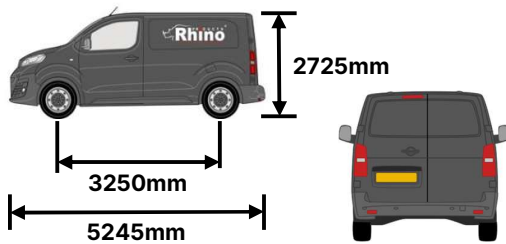

A FN085 Qty	B FN085 Qty	Rear Bar – End (mm)
4	6	510

25.

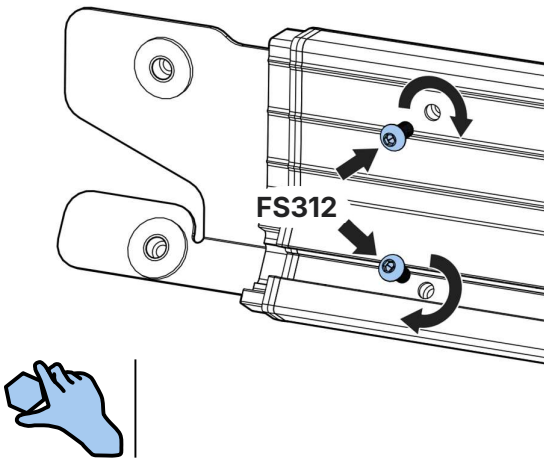

26.

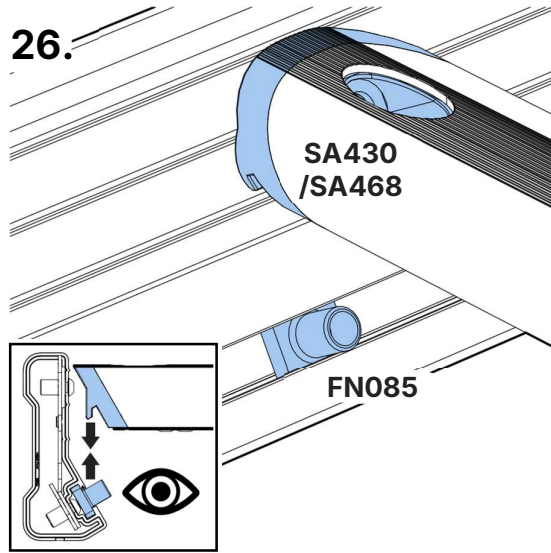

27.

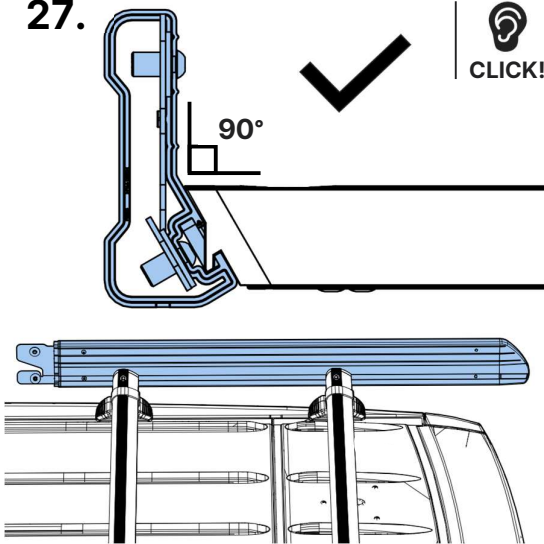

28.

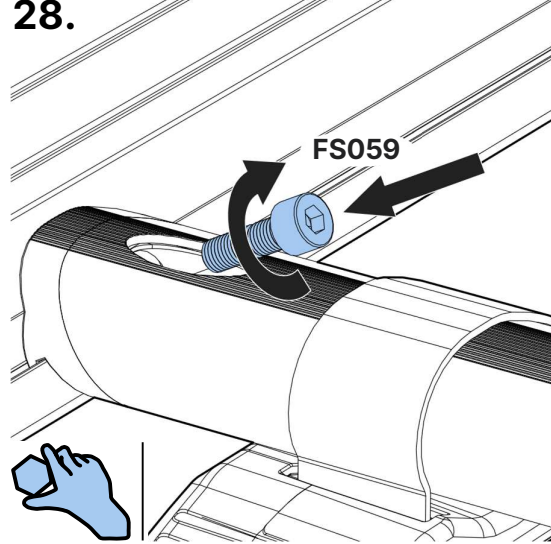

29.

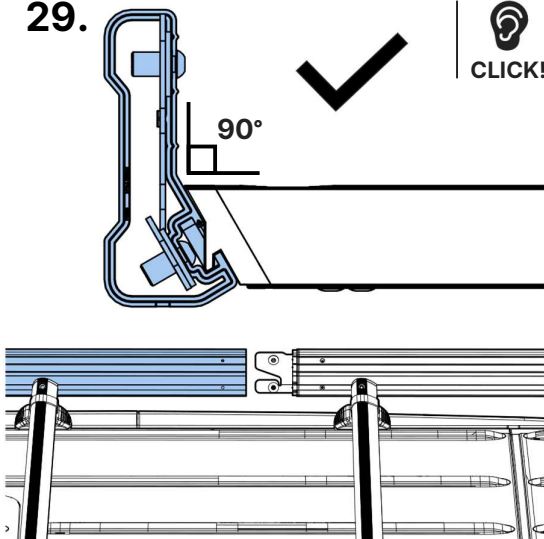

30.

