

Issue:	Drawn By:	Checked By:	CRF No.:	Date:	Description:
a	SJ	KB	3609	21/10/25	First Issue
b					
c					
d					

QD5KE

KammEdge.

Instructions

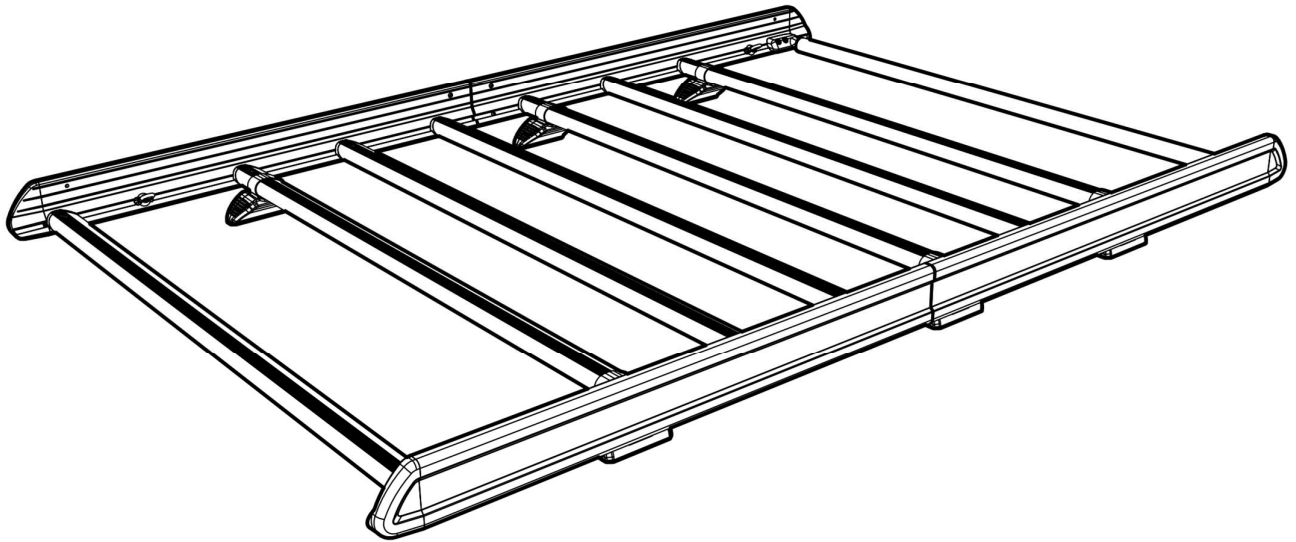

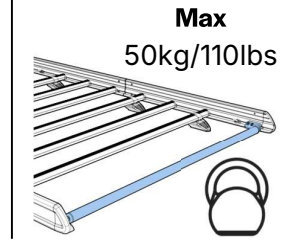
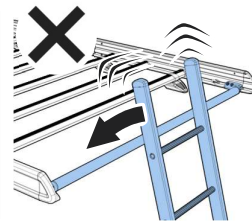
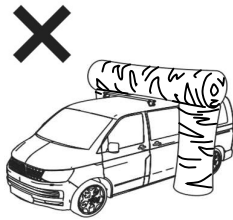
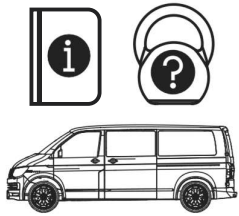

KammEdge.

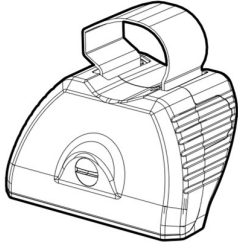

SA397U x 5

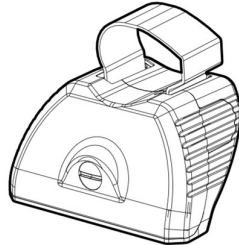

SA398U x 5

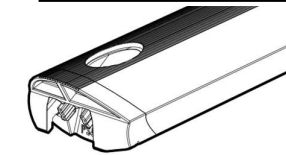

SA430/SA468 x 8/9

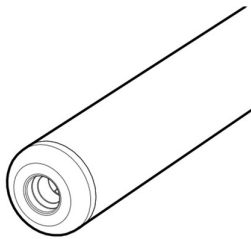

SA438 x 1

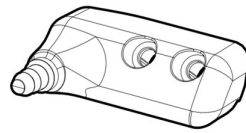

PS519 x 1

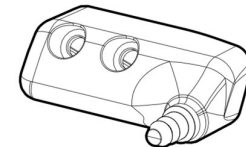

PS520 x 1

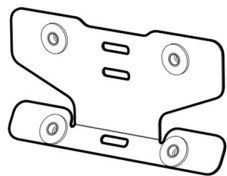

SA610 x 2/4

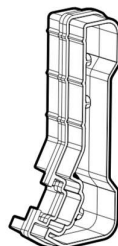

PS635 x 2/4

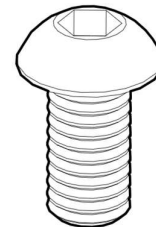

**FS323
(M6 x 16) x 8/16**

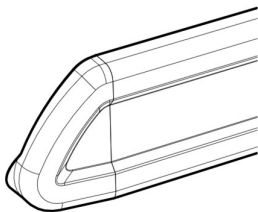

LSF (L) x 2

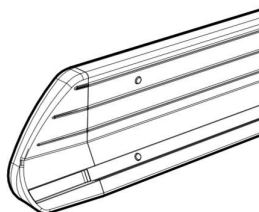

LSF (R) x 2

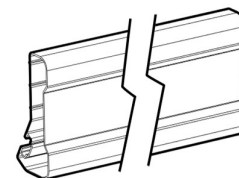

LSF (M) x 0/2



Fitting Kit

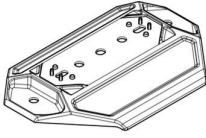

PS625 x 6

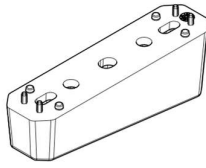

PS175 x 2

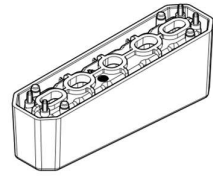

PS626 x 2

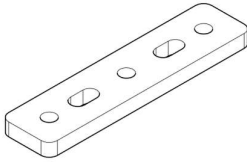

PS623 x 2

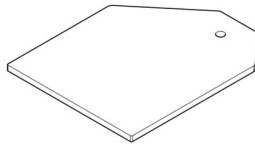

PS629 x 2

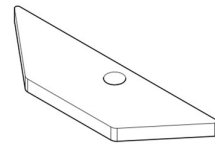

PS628 x 2

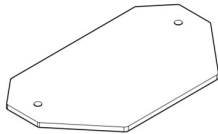

PS627 x 4

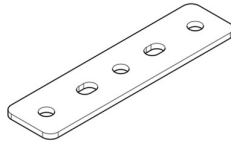

PS023 x 2

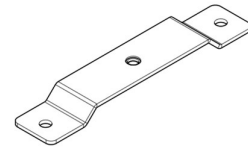

SA459 x 6

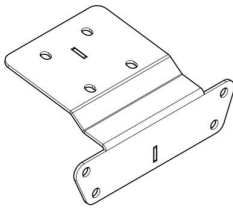

SW526 x 2

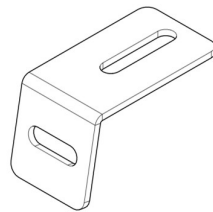

MS2079 x 12

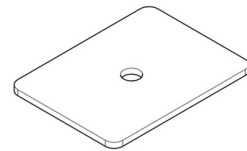

MS2080 x 2

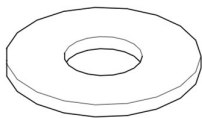

FW002 (M8) x 2

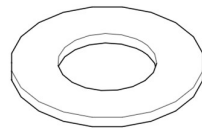

FW021 (M8) x 50

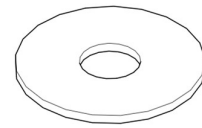

FW036 (M6) x 12



Fitting Kit

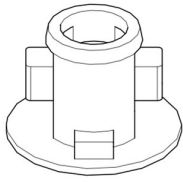

FN003 (M6) x 12

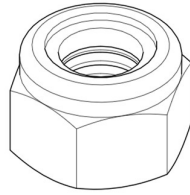

FN006 (M8) x 22

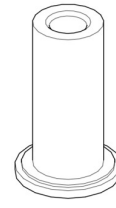

FN079 (M8) x 4

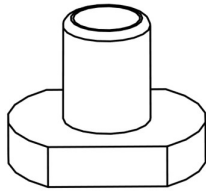

FN085 (M8) x 22

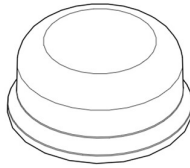

PS414 (M8) x 16

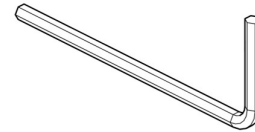

FT05 x 1

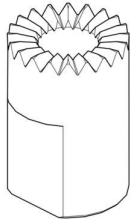

TP157 x 1

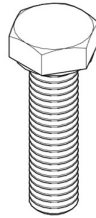

**FB006
(M8 x 30) x 16**

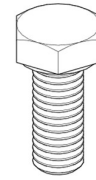

**FS067
(M8 x 20) x 6**

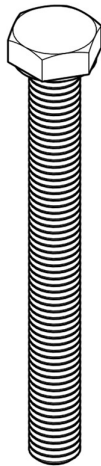

**FS107
(M8 x 75) x 4**

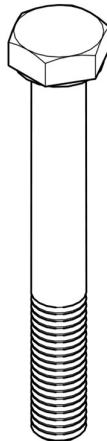

**FB003
(M8 x 65) x 2**

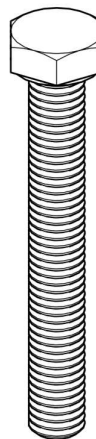

**FS091
(M8 x 60) x 1**

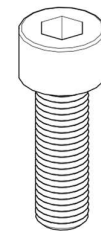

**FS059
(M8 x 25) x 22**

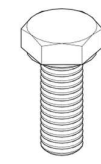

**FS041
(M6 x 16) x 12**



1a.

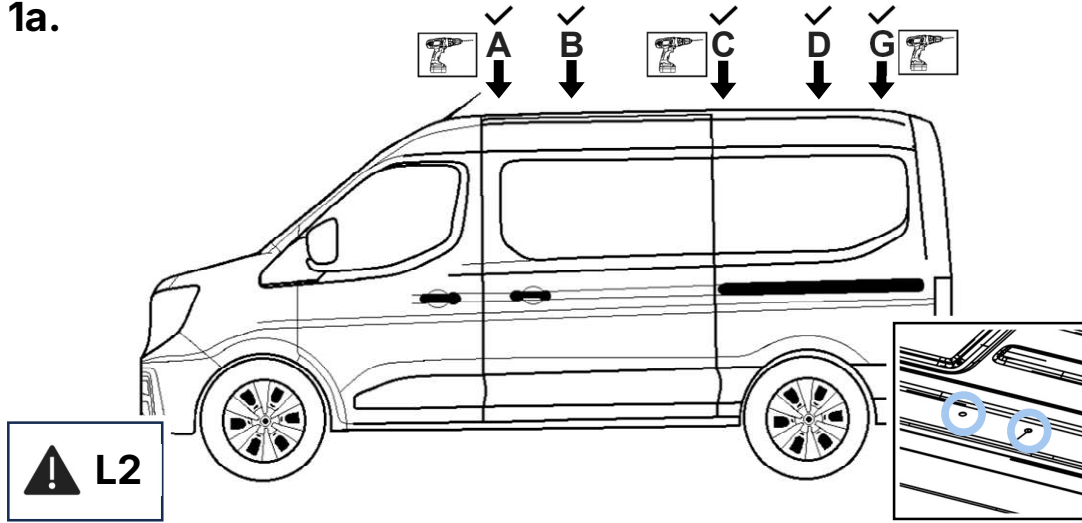

1b.

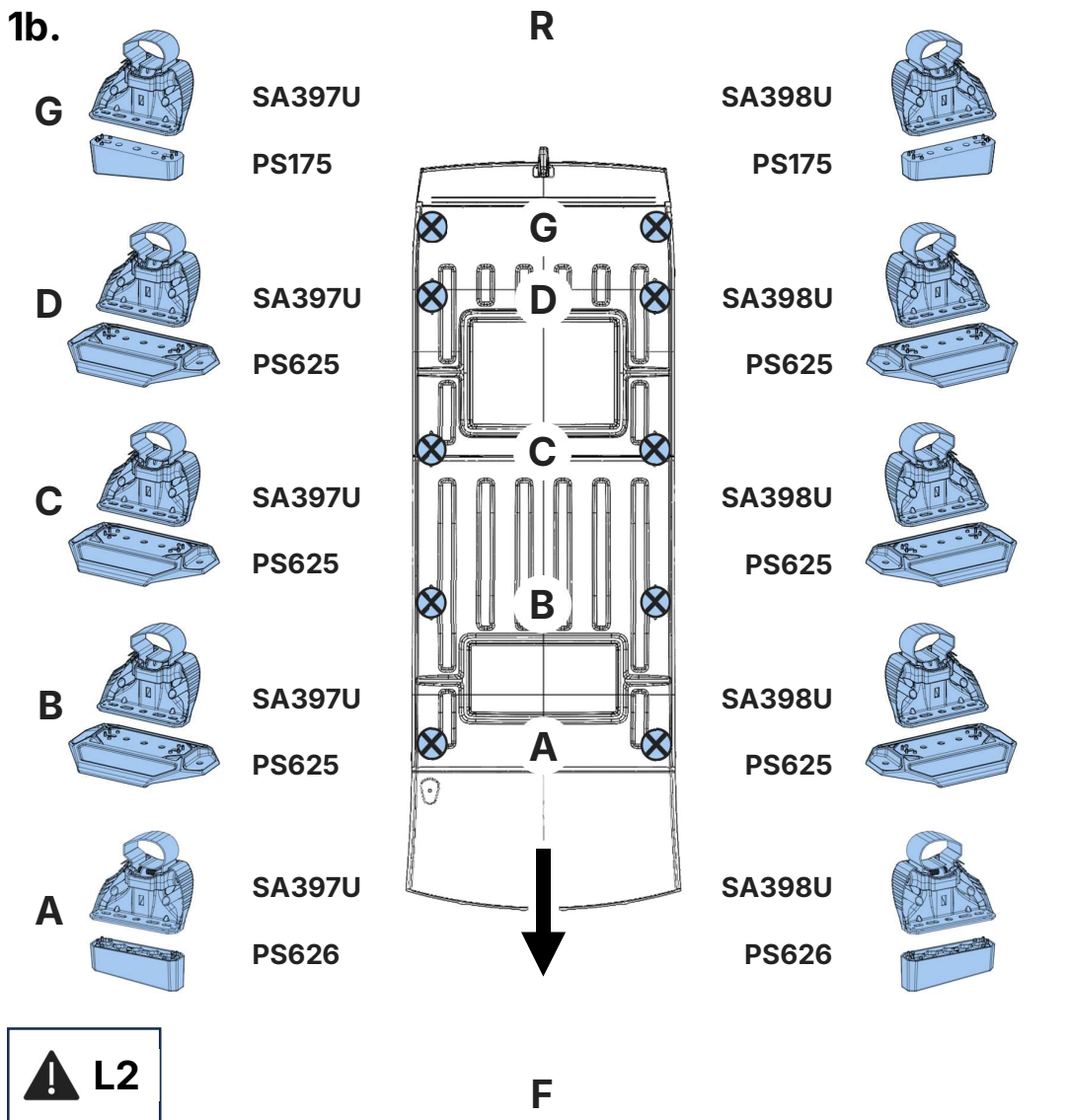

2a.

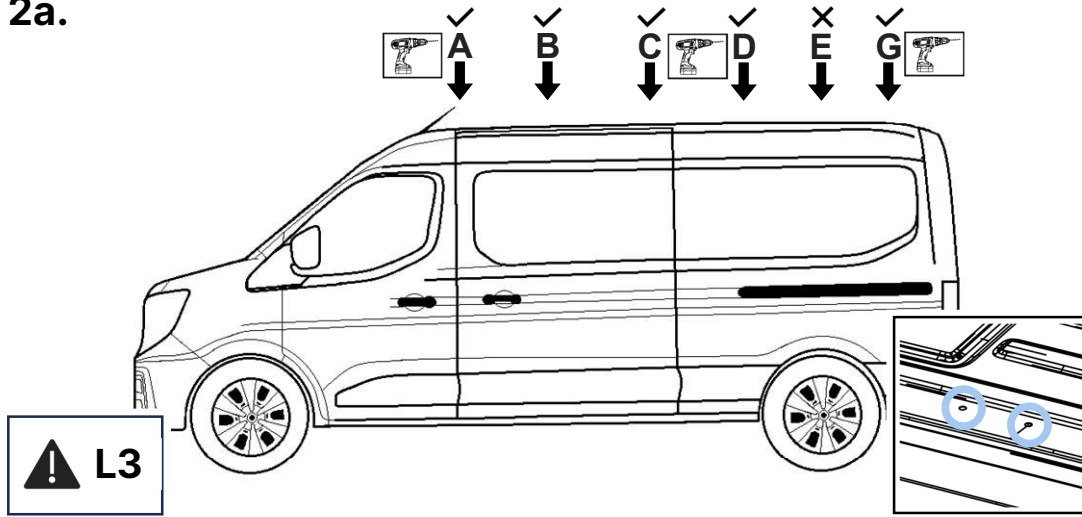

2b.

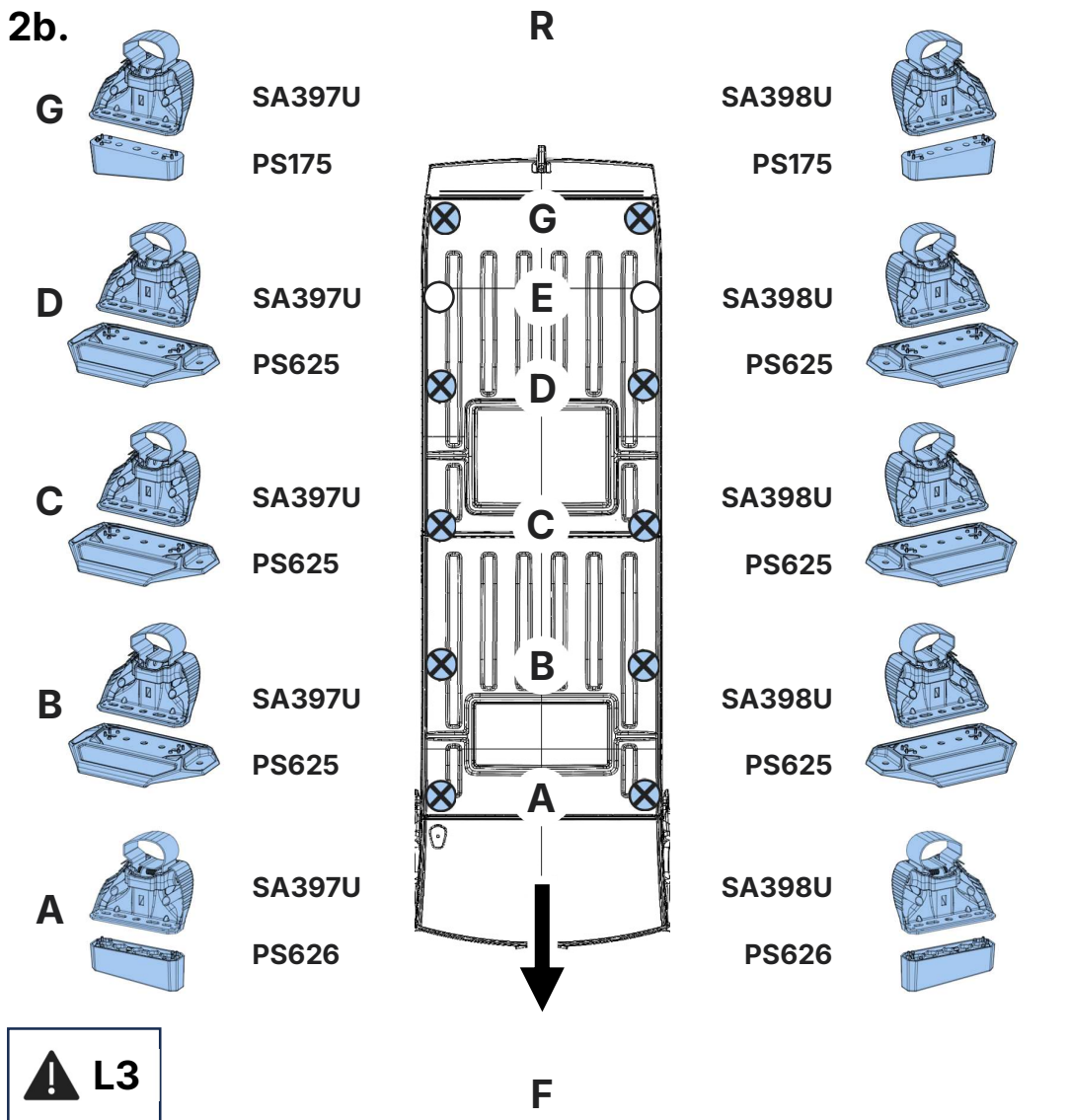

3.

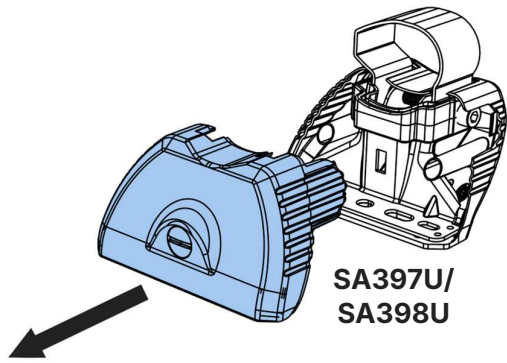

4.

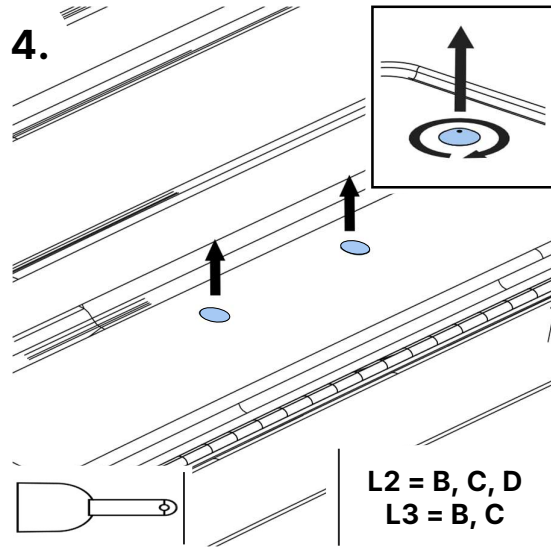

5.

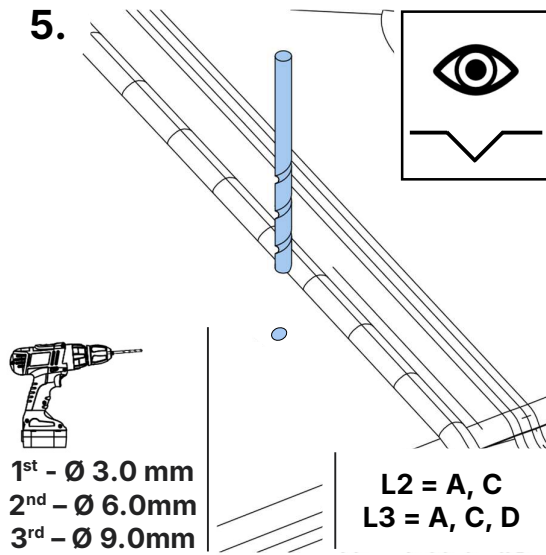

6.

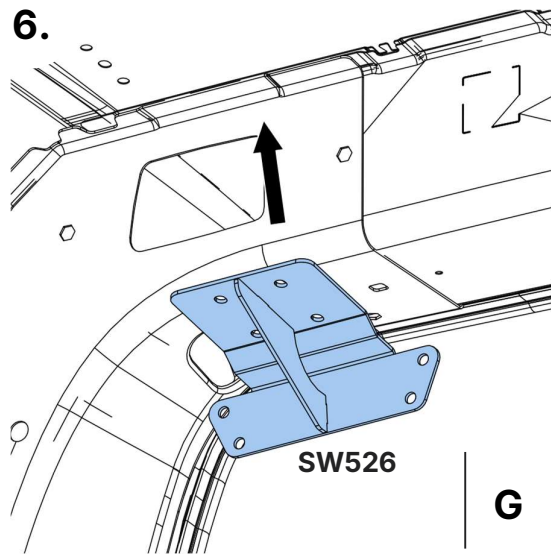

7.

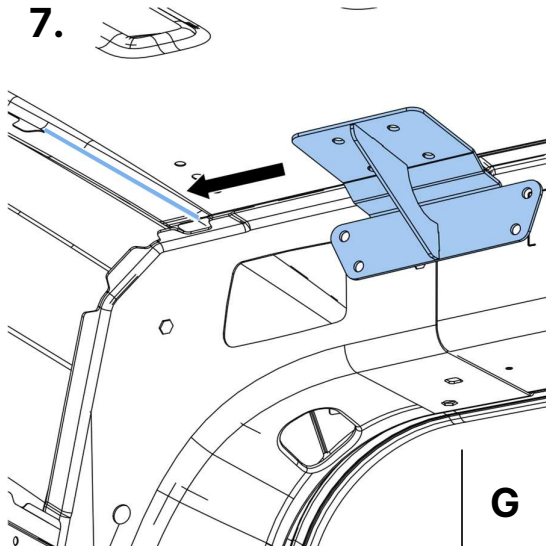

8.

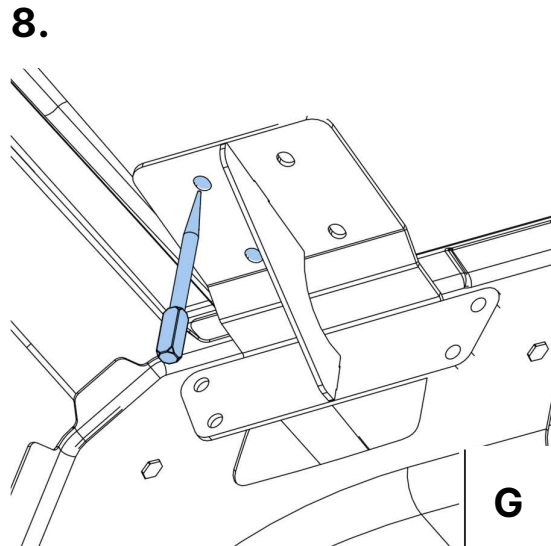

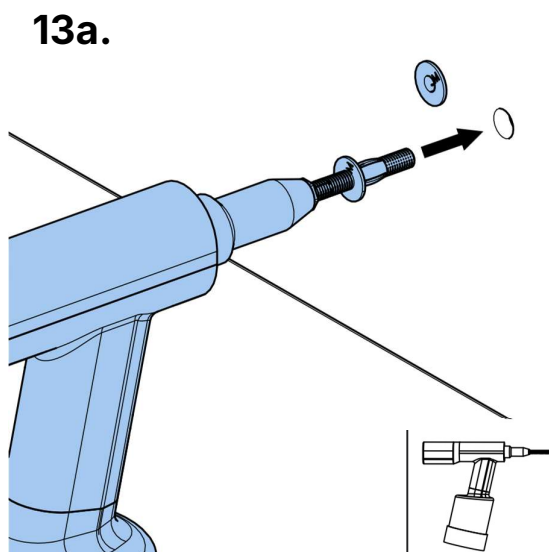
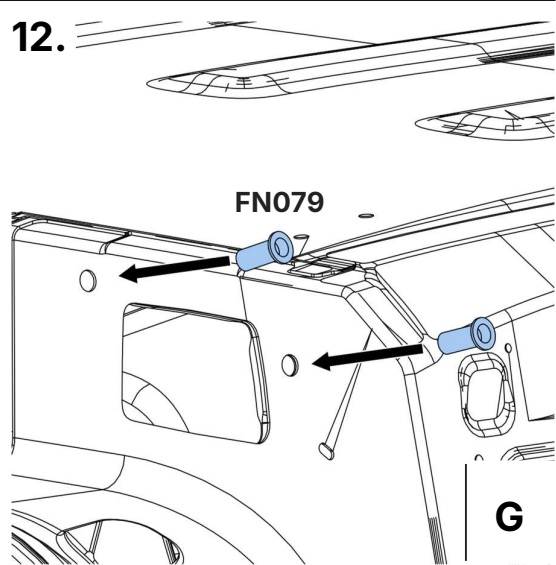
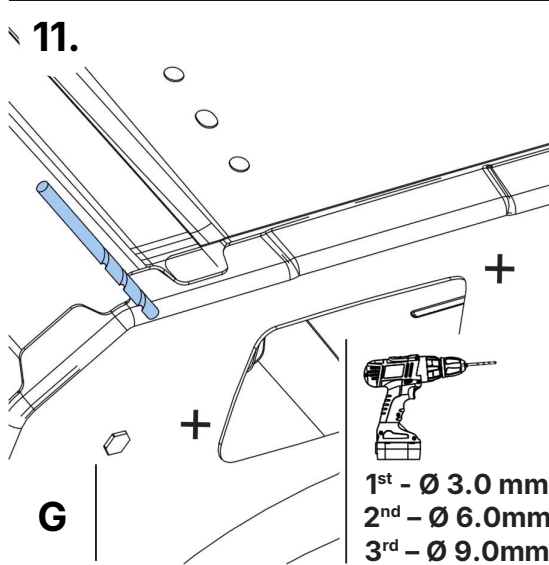
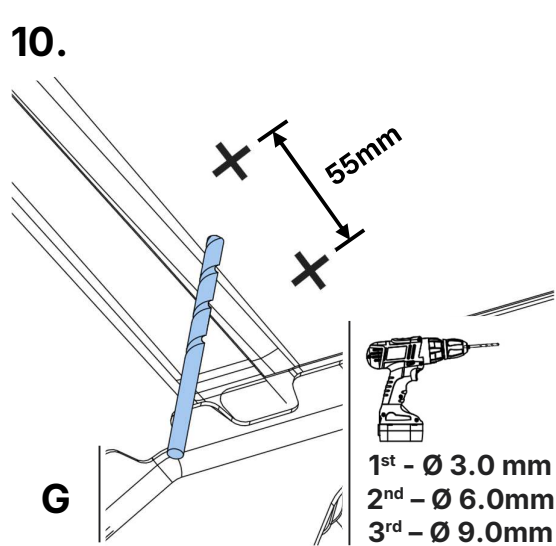
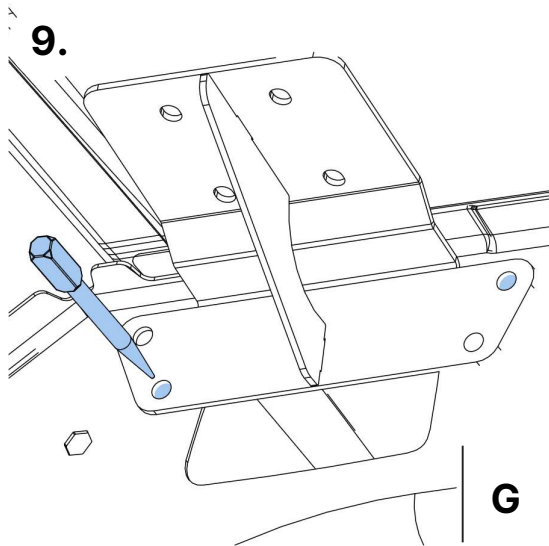

	Option 1: Use Rivet Gun & M8 XL Mandrel.
	Option 1: Benutzen Sie eine Nietpistole & einen M8 XL Zugdorn.
	Option 1: Utiliser un pistolet à riveter et un mandrin M8 XL.
	Opzione 1: utilizzare una pistola per rivetti e un mandrino M8 XL.
	Opción 1: Use la remachadora y el cabezal M8 XL.
	Opcja 1: należy użyć nitownicy z trzpieniem M8 XL.
	Optie 1: Gebruik Klanknagelpistool & M8 XL Opspandoorn.
	1. opció Használjon szegecselő pisztolyt és M8 XL tűskét.
	Alternativ 1: Använd en nitpistol och en M8 XL borraradapter.
	Varianta 1: Použijte nýtovací kladivo a trn M8 XL.
	Vaihtoehto 1: Käytä niittivasaraa ja M8 XL -tuurnaa.
	Alternativ 1: Bruk naglepistol og M8 XL-mandreng.
	Možnosť 1: Použite nitovací pištoľ a trň M8 XL.

13b.

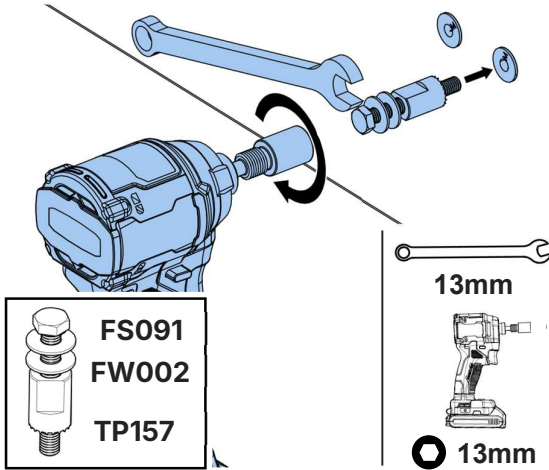

	Option 2: Use Impact Driver.
	Option 2: Benutzen Sie einen Schlagschrauber.
	Option 2 : Utiliser une clé à choc.
	Opzione 2: utilizzare l'avvitatore a percussione.
	Opción 2: Use el atornillador de impacto.
	Opcja 2: należy użyć wkrętarki udarowej.
	Optie 2: Gebruik Slagschroevendraaier.
	2. opció Használgjon ütvefúrót.
	Alternativ 2: Använd en slagbormmaskin.
	Varianta 2: Použijte příklepový utahovák.
	Vaihtoehto 2: Käytä iskuväännintä.
	Alternativ 2: Bruk slagskrutrekker.
	Možnosť 2: Použite elektrický utahovák.

13c.

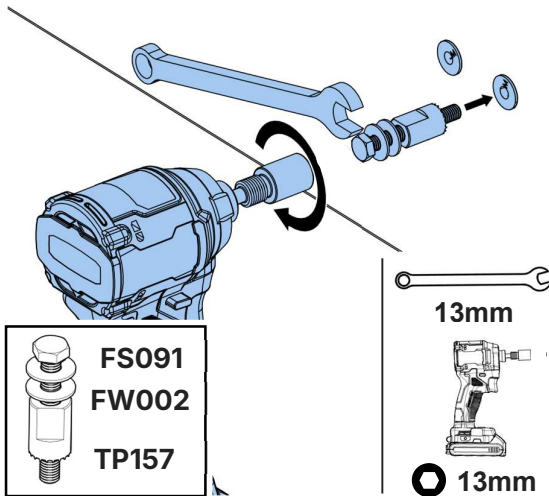

	Option 2: Use Impact Driver.
	Option 2: Benutzen Sie einen Schlagschrauber.
	Option 2 : Utiliser une clé à choc.
	Opzione 2: utilizzare l'avvitatore a percussione.
	Opción 2: Use el atornillador de impacto.
	Opcja 2: należy użyć wkrętarki udarowej.
	Optie 2: Gebruik Slagschroevendraaier.
	2. opció Használgjon ütvefúrót.
	Alternativ 2: Använd en slagbormmaskin.
	Varianta 2: Použijte příklepový utahovák.
	Vaihtoehto 2: Käytä iskuväännintä.
	Alternativ 2: Bruk slagskrutrekker.
	Možnosť 2: Použite elektrický utahovák.

14.

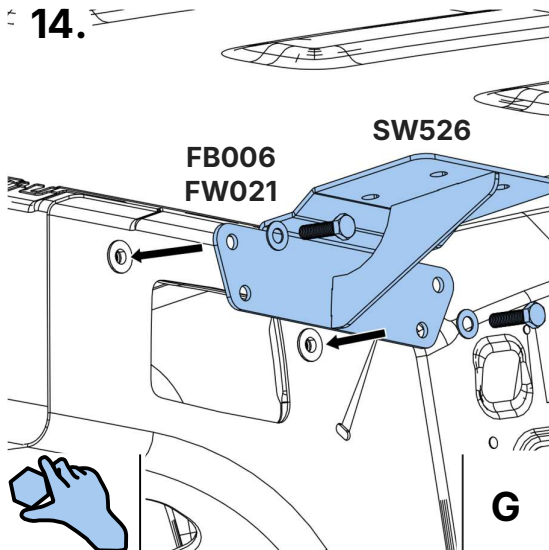

15.

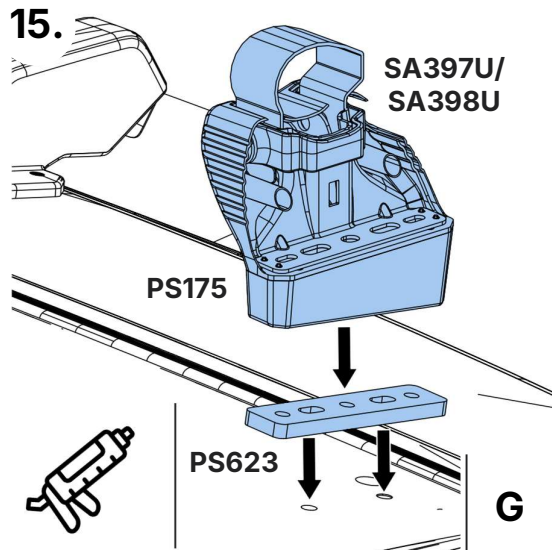

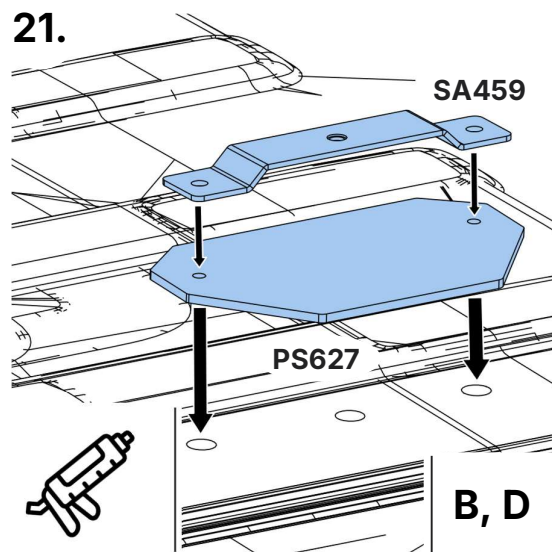
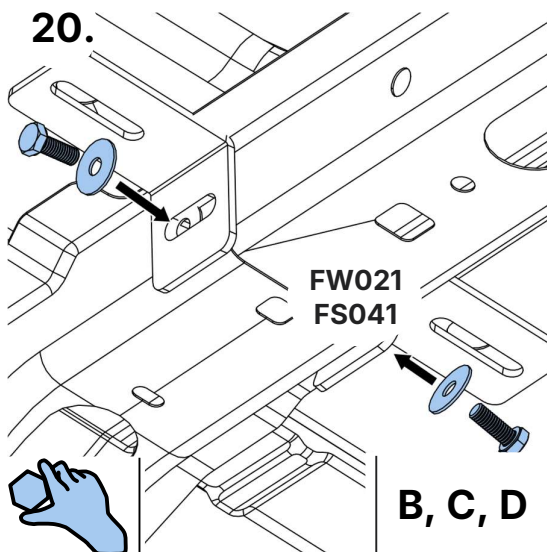
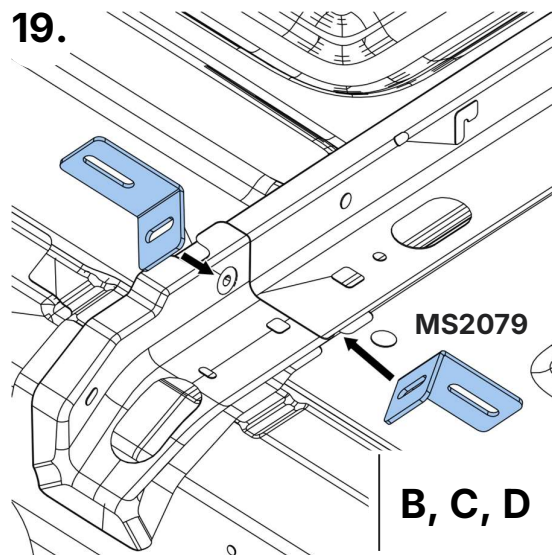
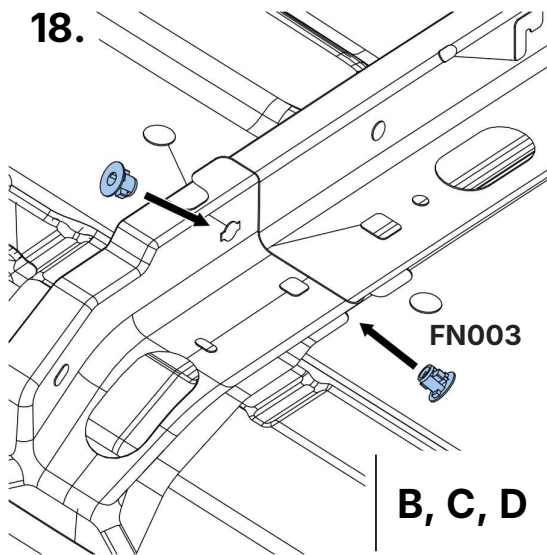
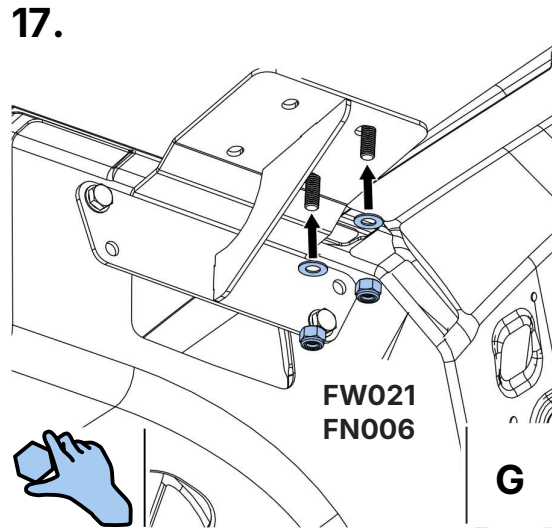
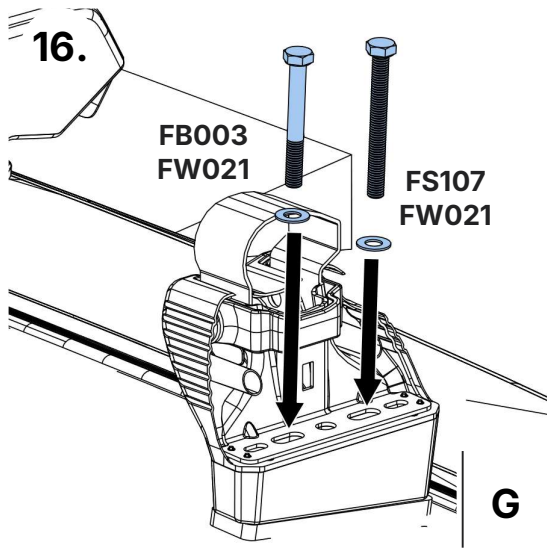

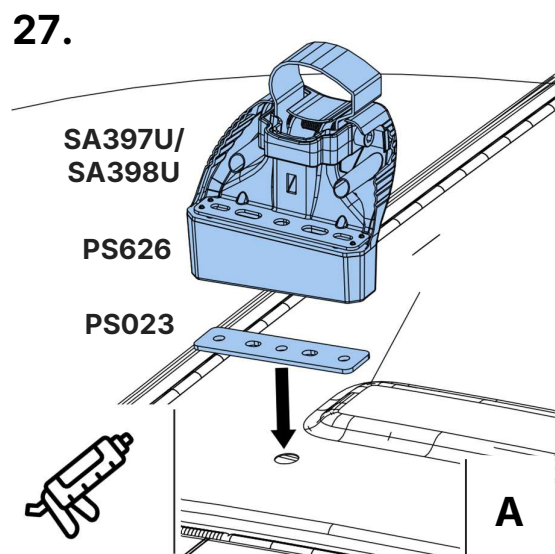
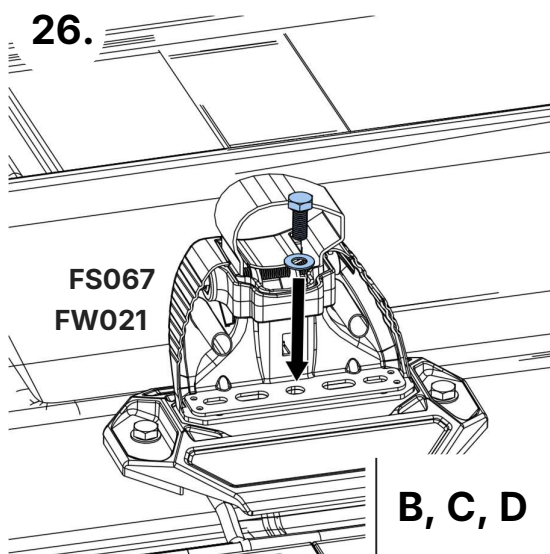
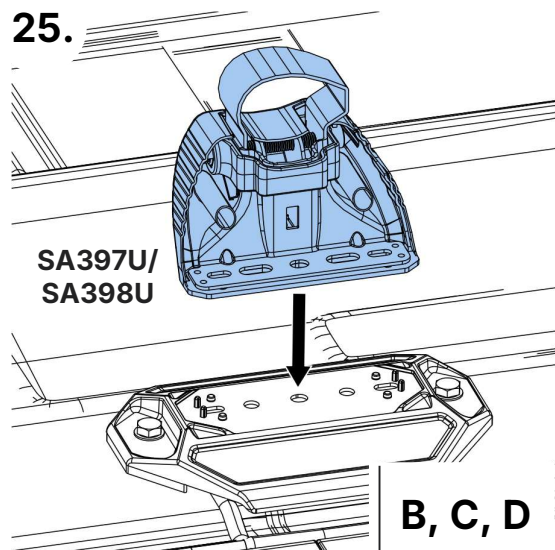
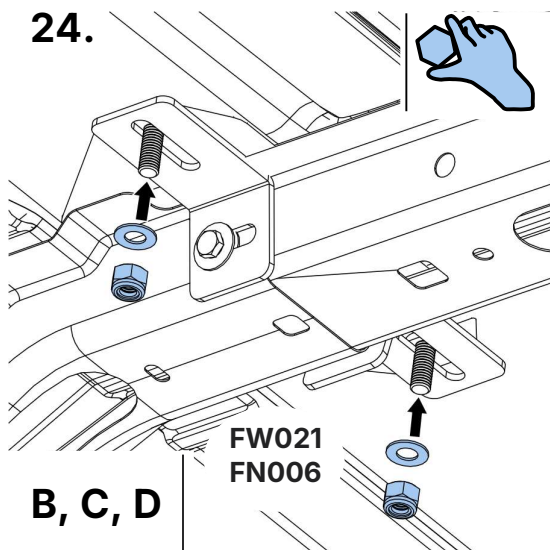
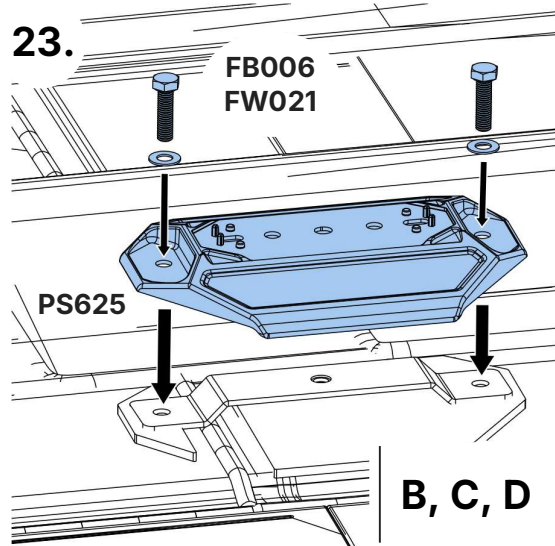
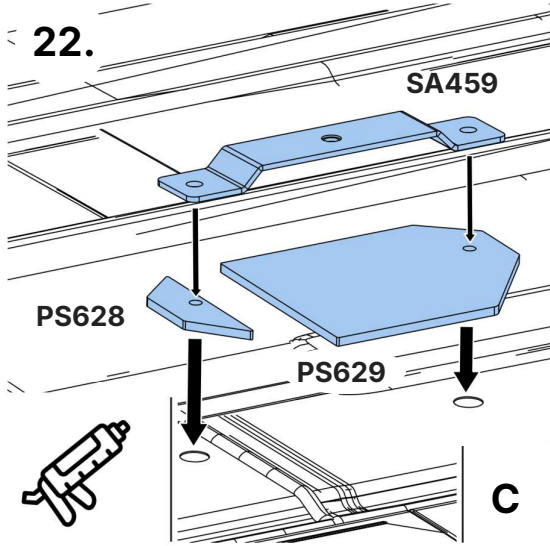

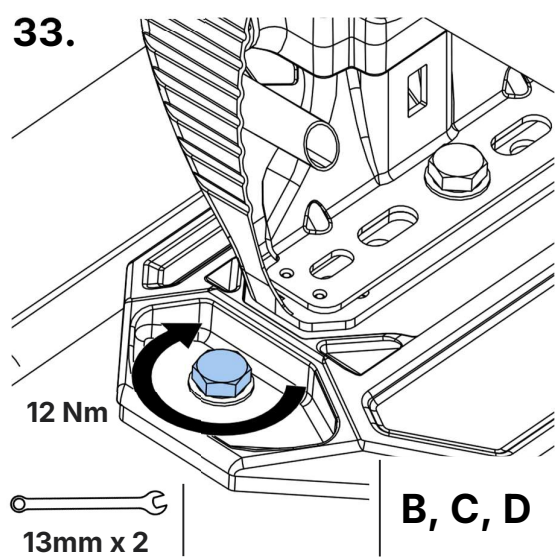
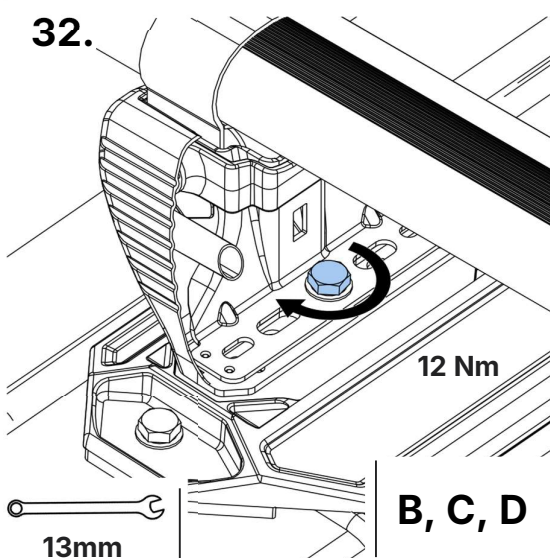
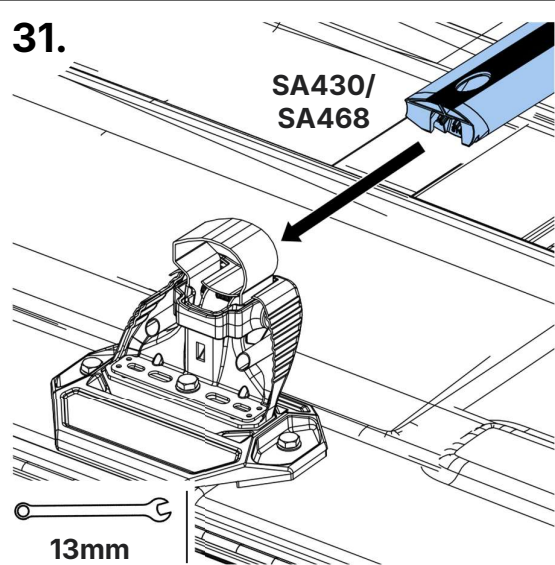
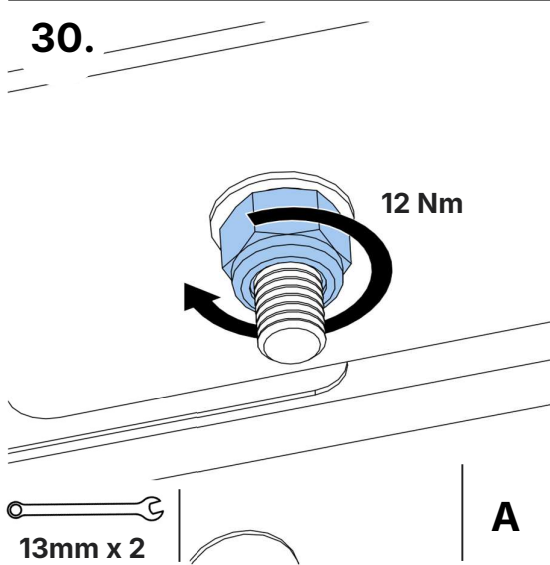
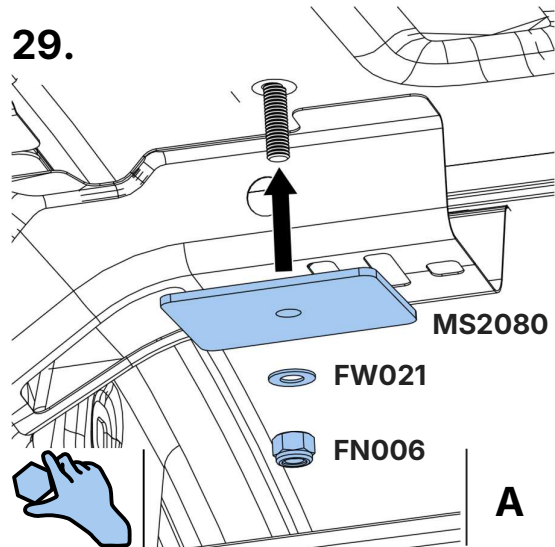
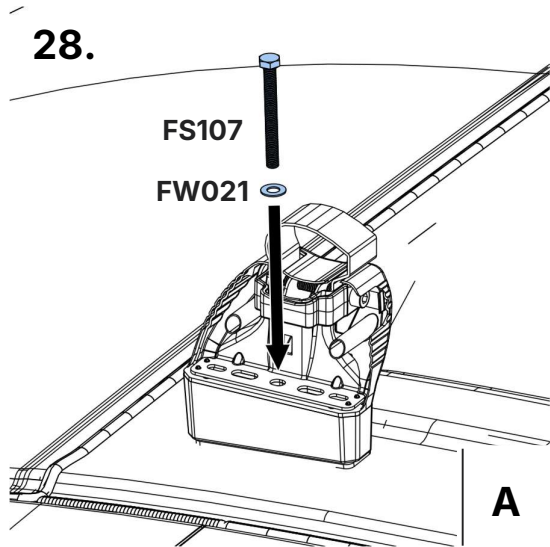

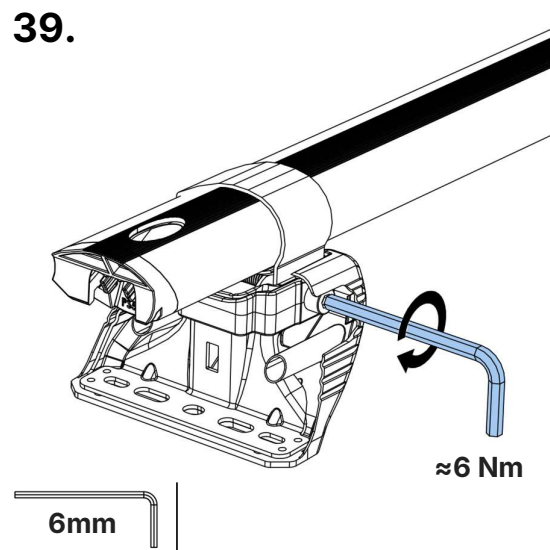
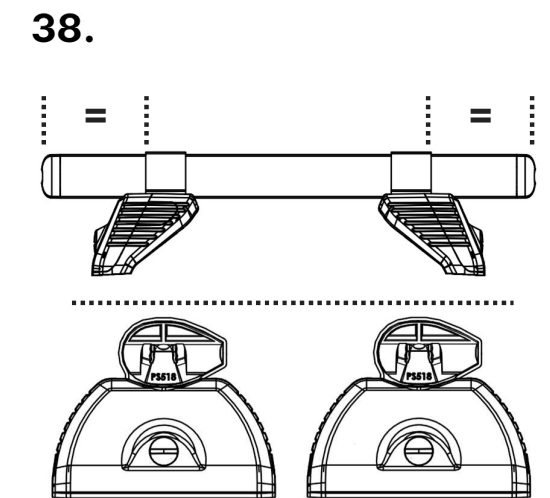
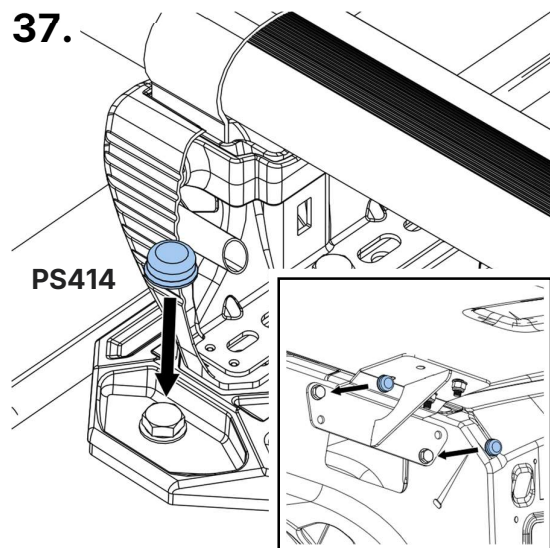
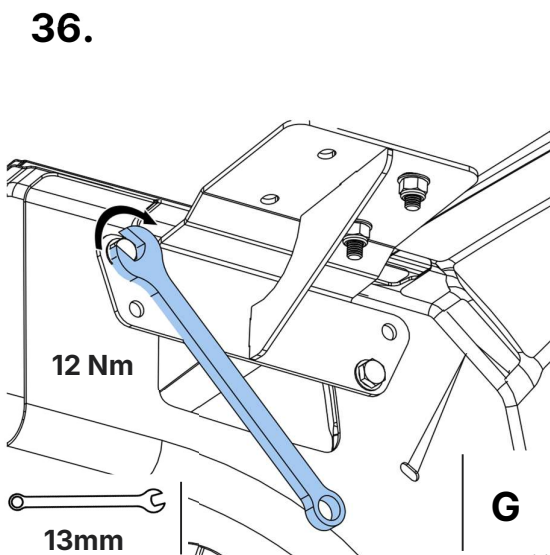
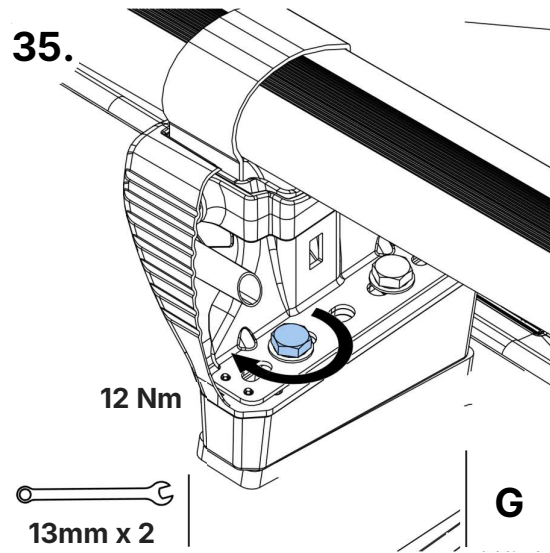
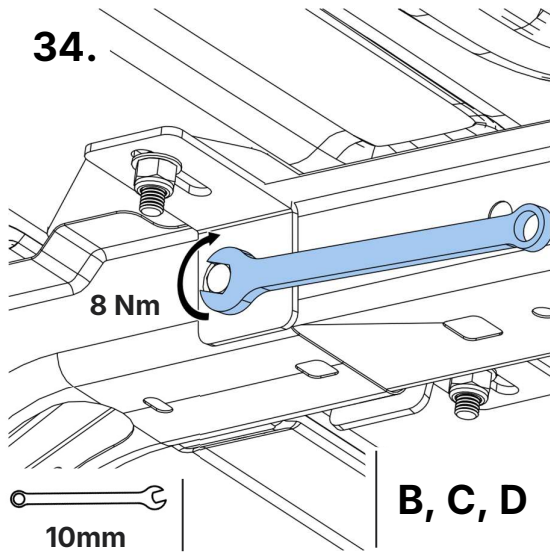

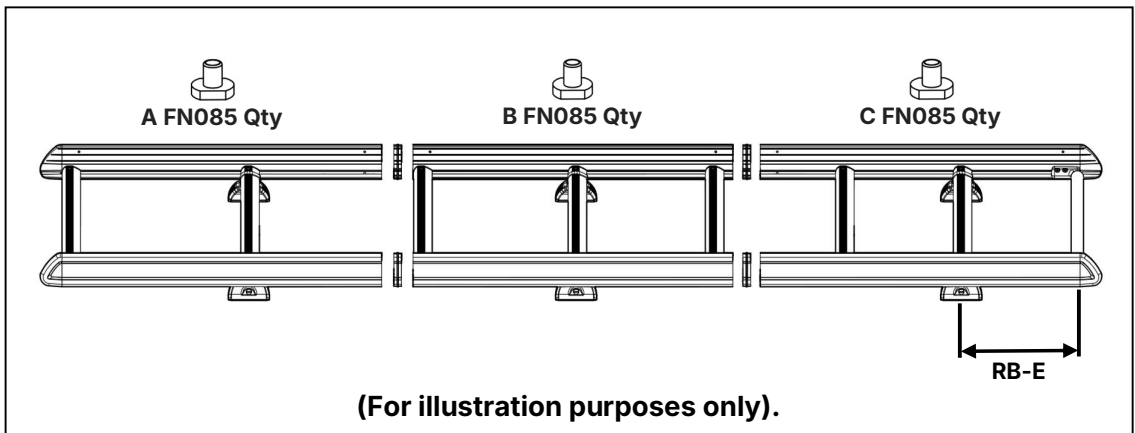
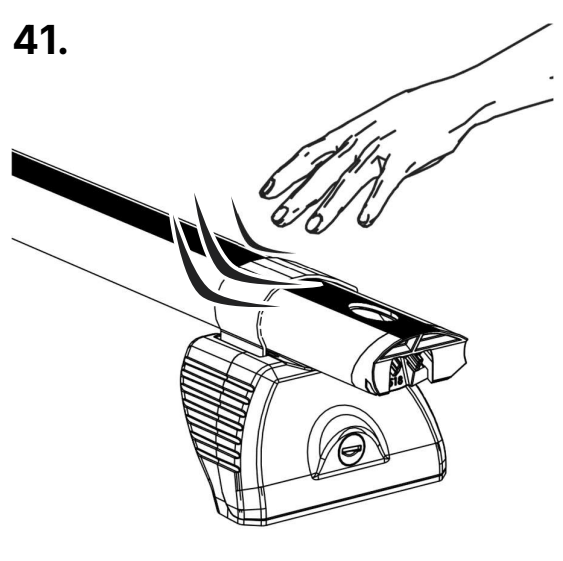
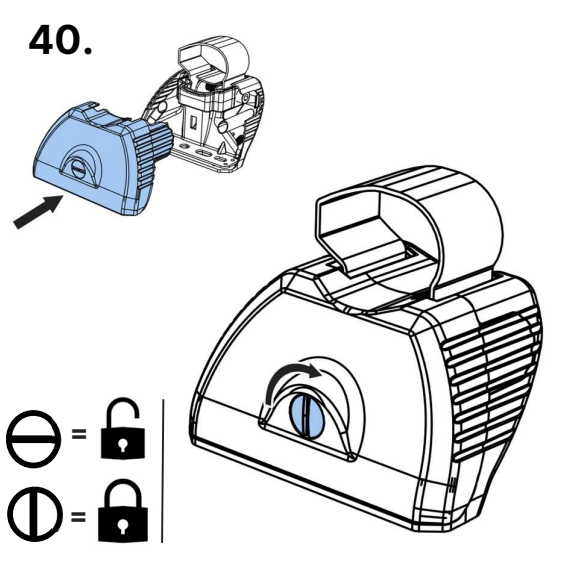

L697/LB697- Master XDD/Interstar 2024-, L3-H2 (Twin)			
<p>Max Load = 150kg/330lbs</p> <p>L697/LB697 = 37/82lbs</p>			
A FN085 Qty	B FN085 Qty	C FN085 Qty	Rear Bar – End (mm)
4	2	5	340
42-63, 77-87.			

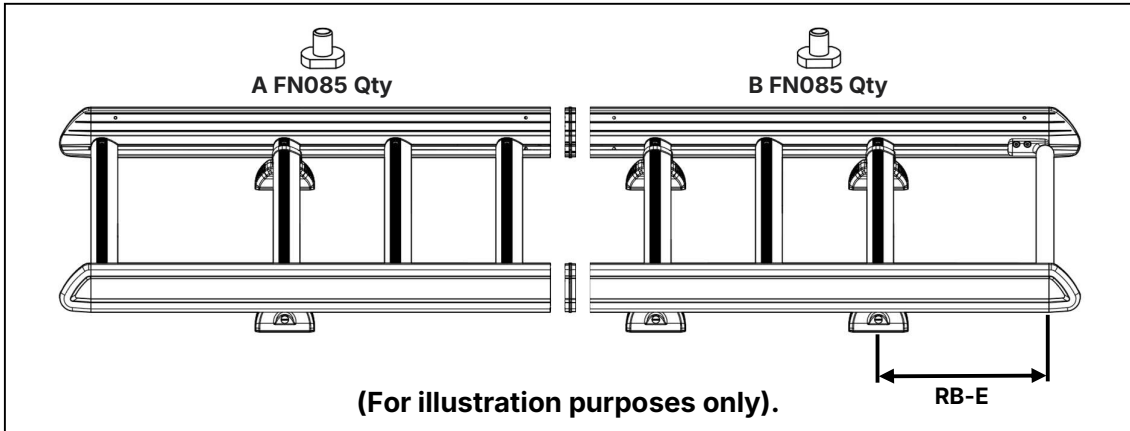

L696/LB696- Master XDD/Interstar 2024-, L2-H2 (Twin)

Max Load = 150kg/330lbs



L696/LB696 = 37/82lbs

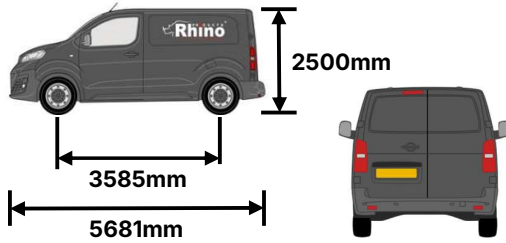

A FN085 Qty	B FN085 Qty	Rear Bar – End (mm)
4	6	300
42-46,64-87.		

48.

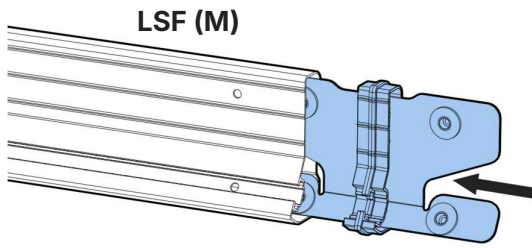

49.

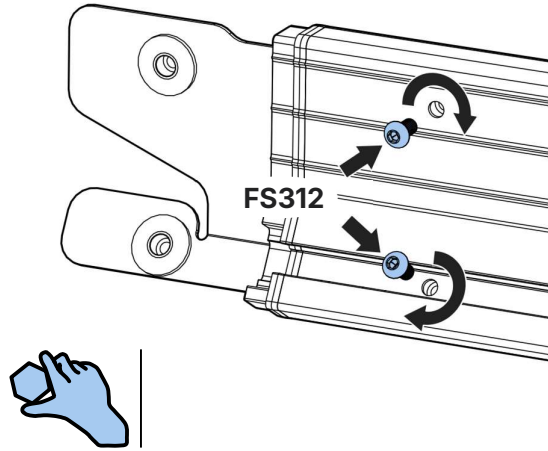

50.

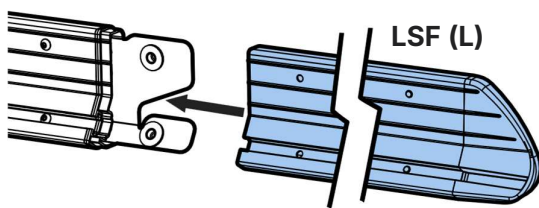

51.

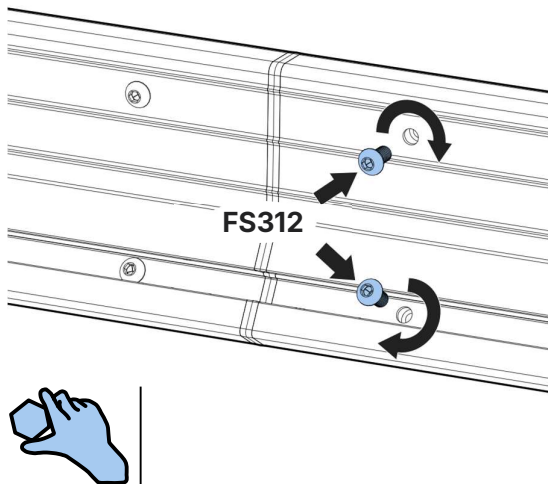

52.

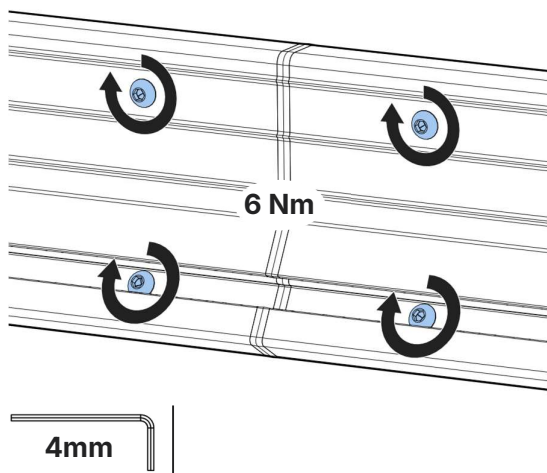

53.

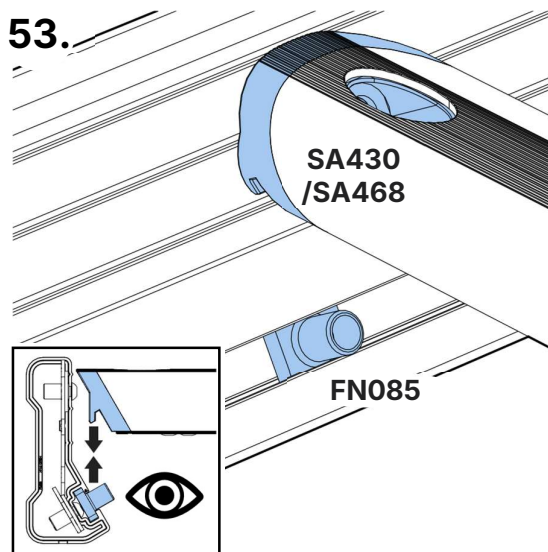

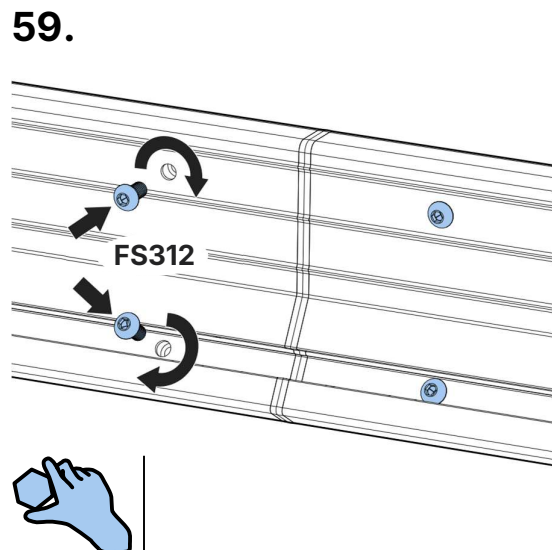
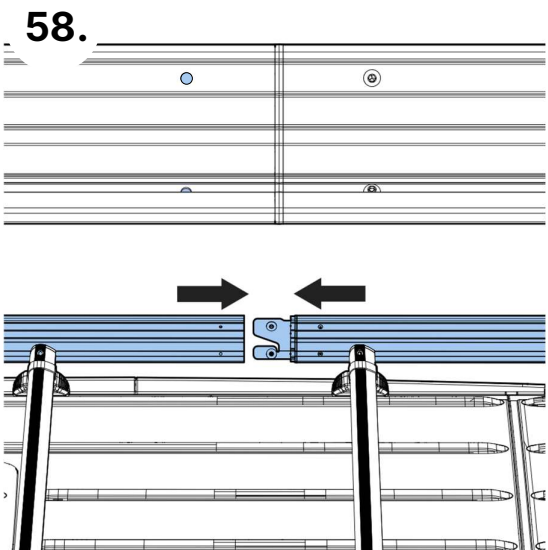
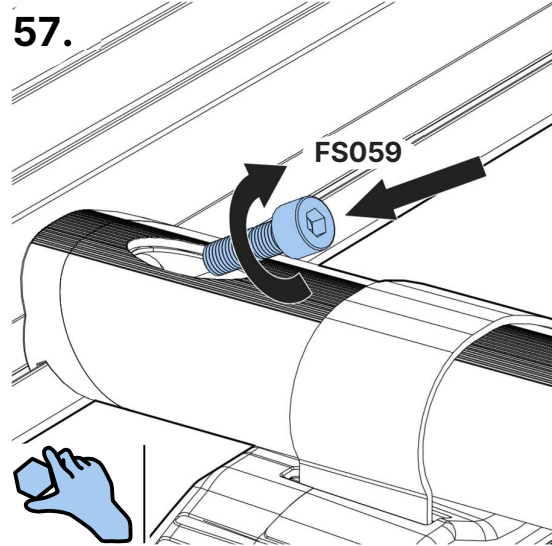
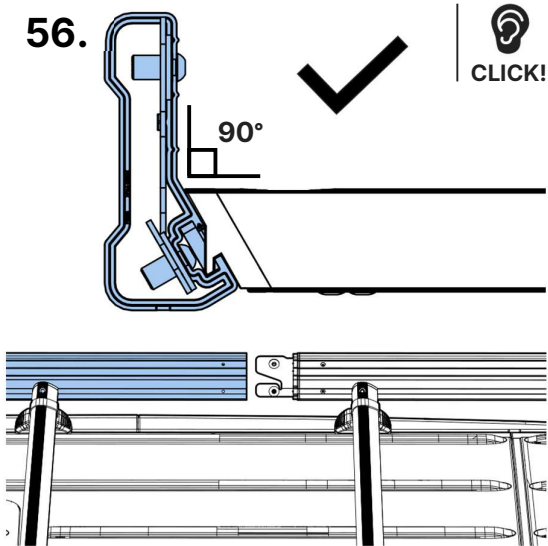
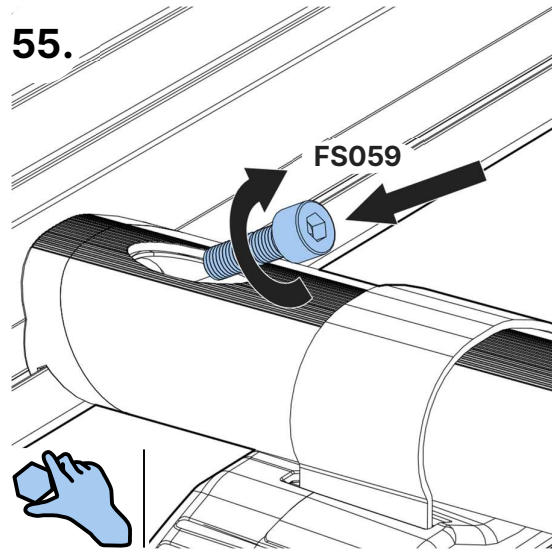
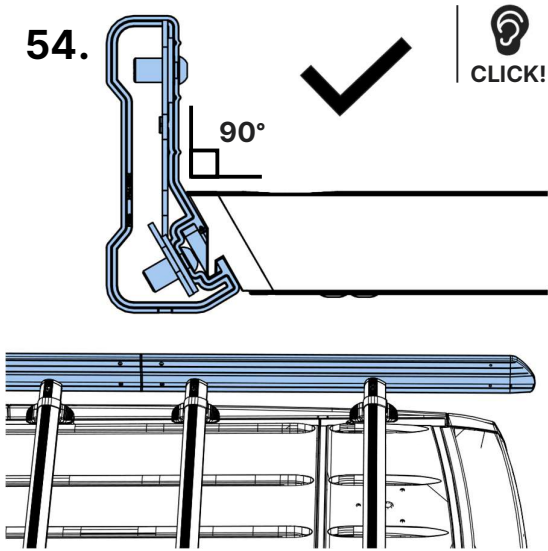

60.

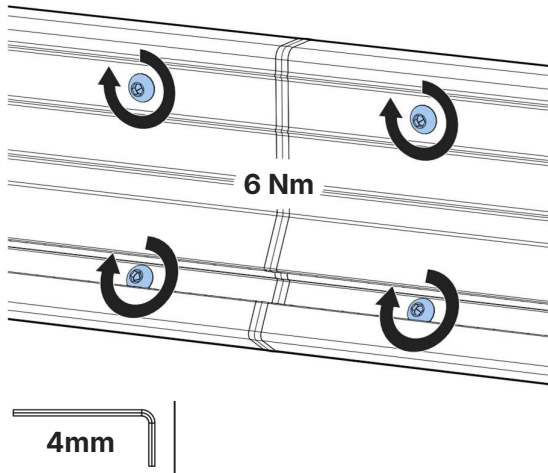

61.

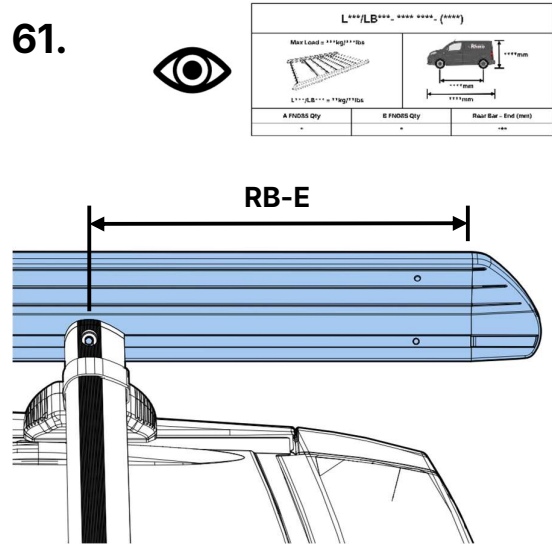

62.

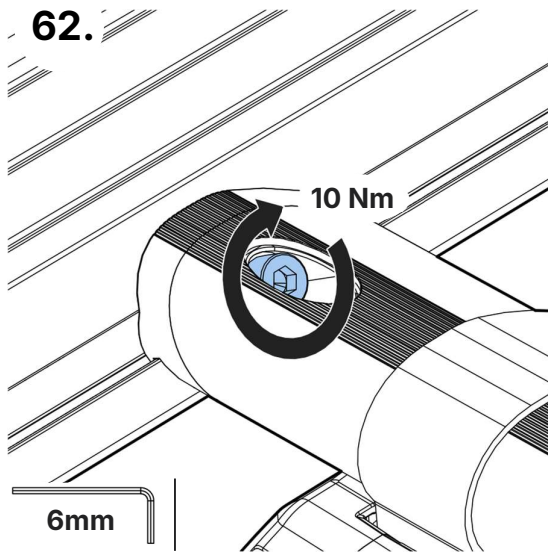

63.

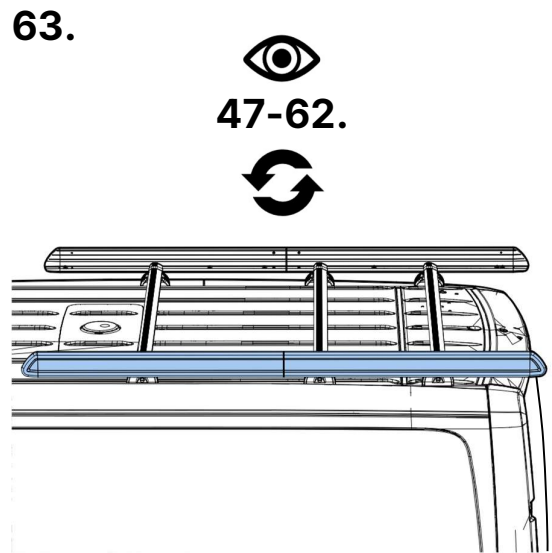

64.

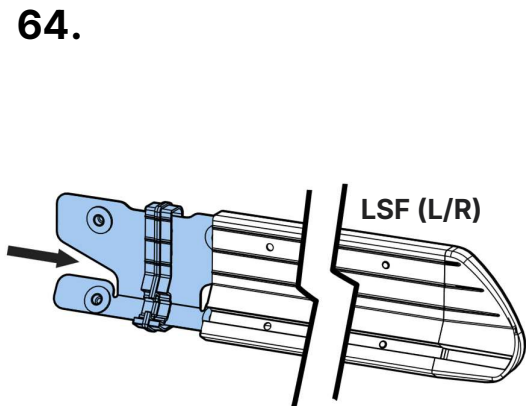

65.

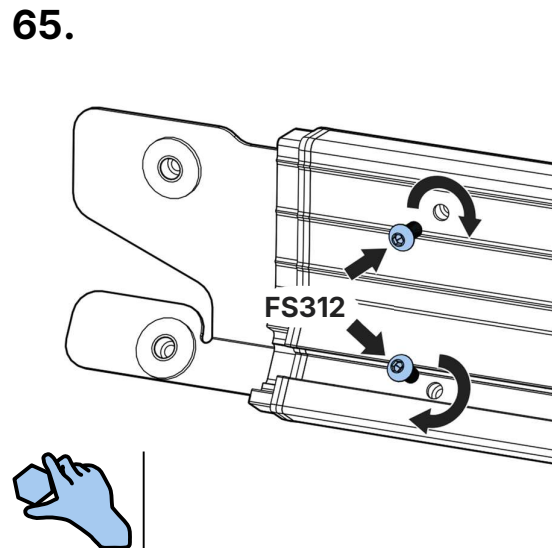

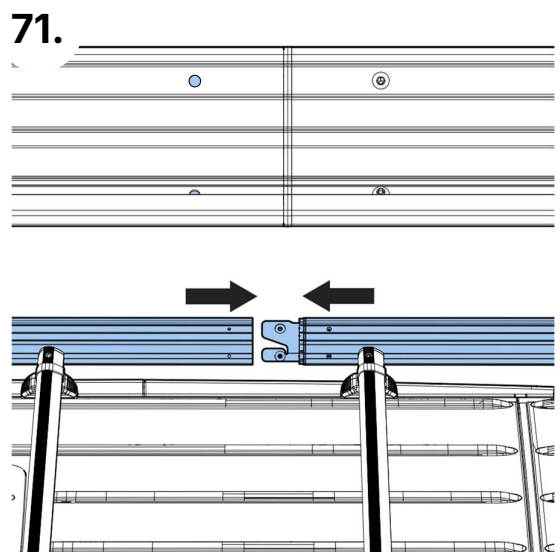
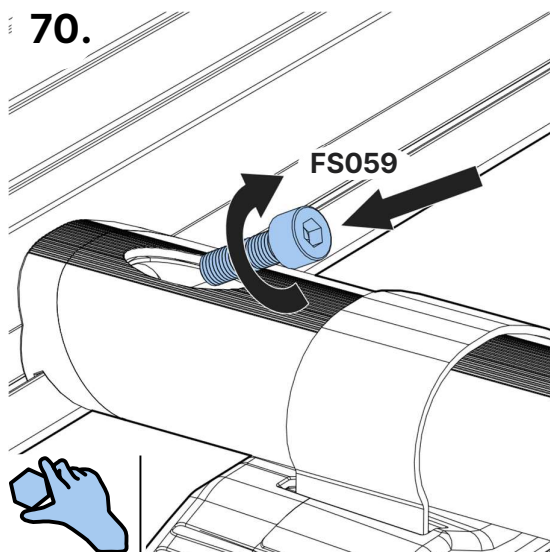
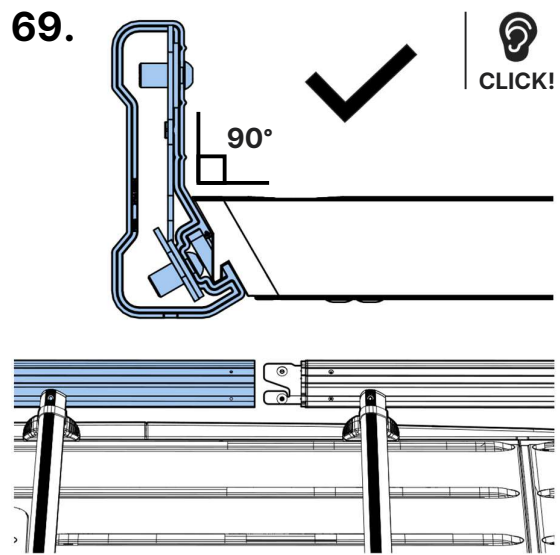
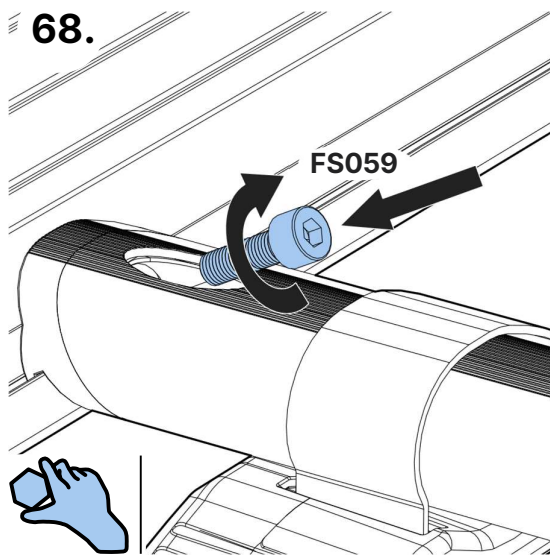
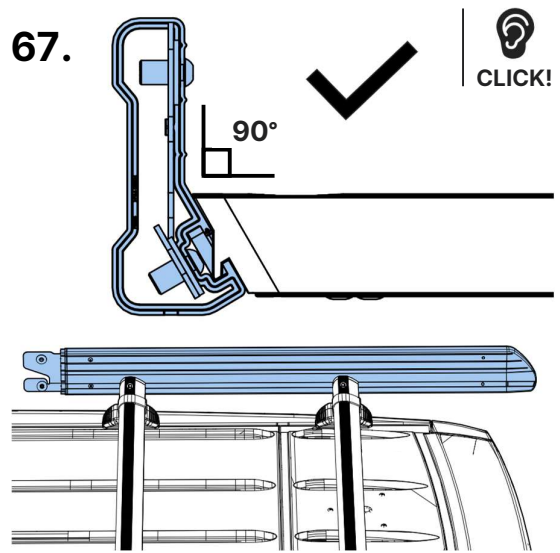
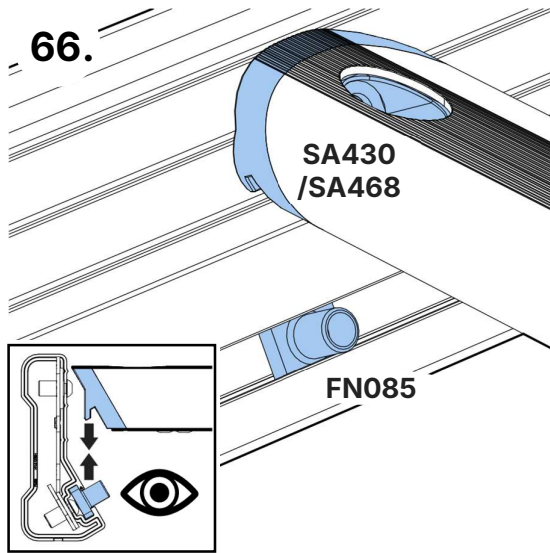

72.

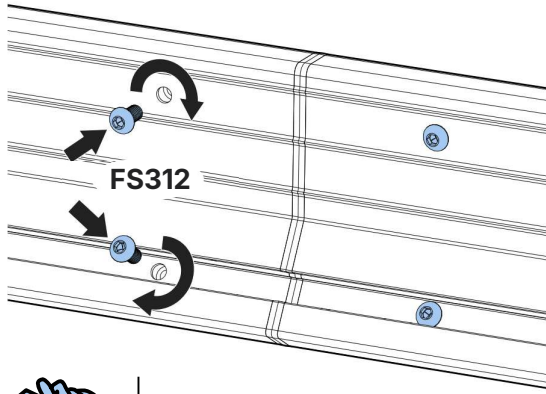

73.

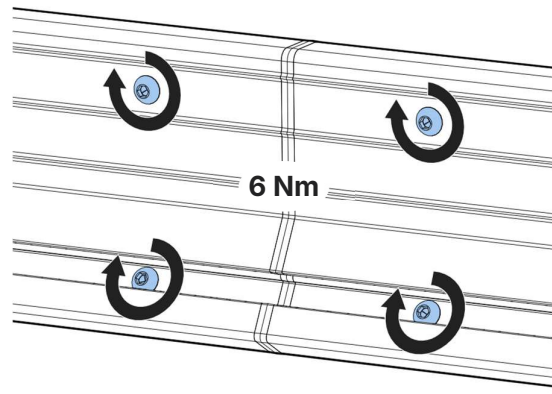

74.



L***LB***, *** ***(***)		
Max Load = 11kg/110kg		
L***LB*** = 11kg/110kg	1100mm	1100mm
A Model Qty	B Model Qty	Rear Bar - End (Per)

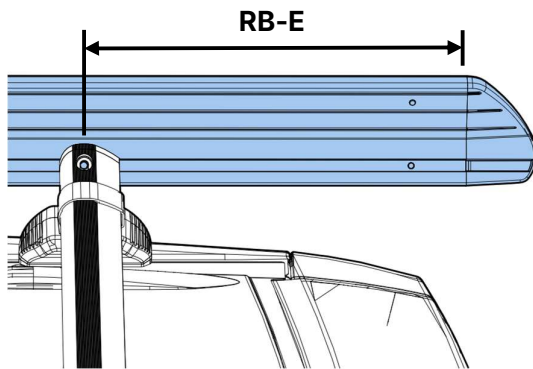

75.

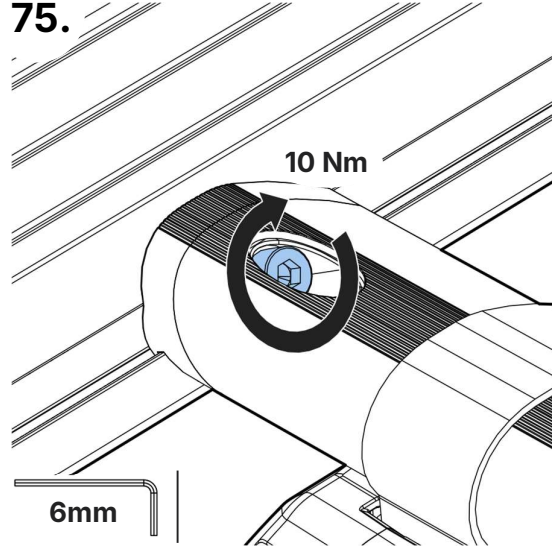

76.



64-75.

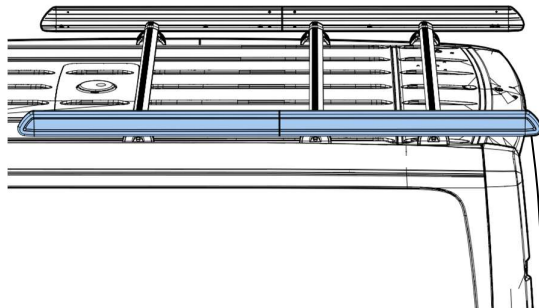

77.

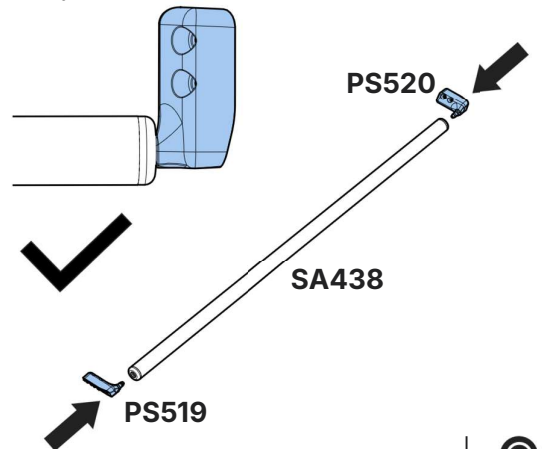

78.

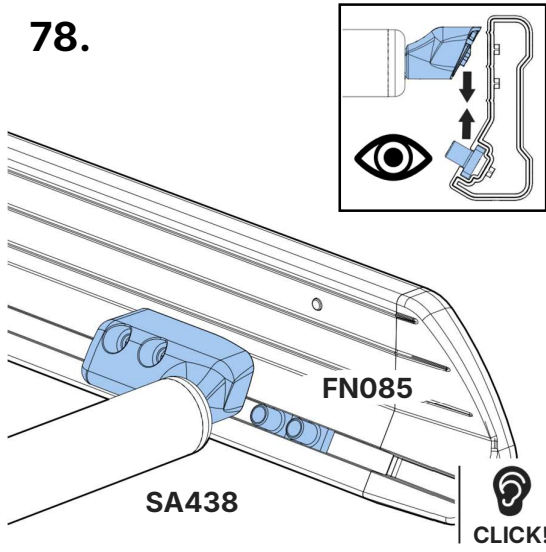

79.

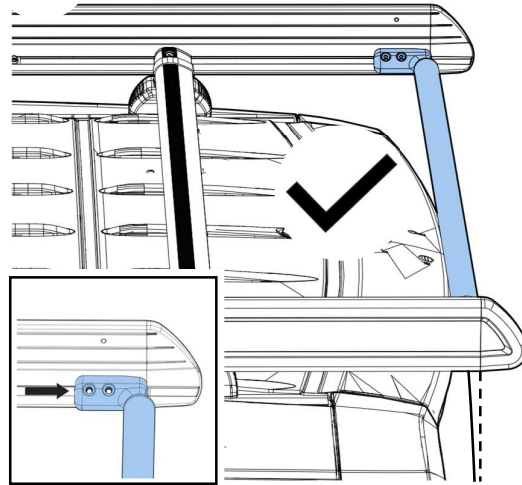

80.

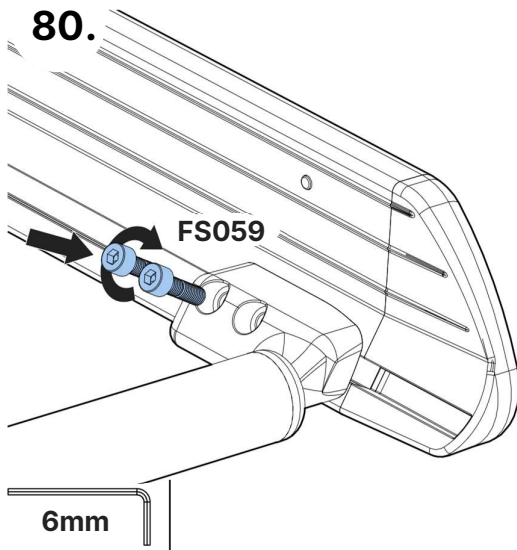

81.

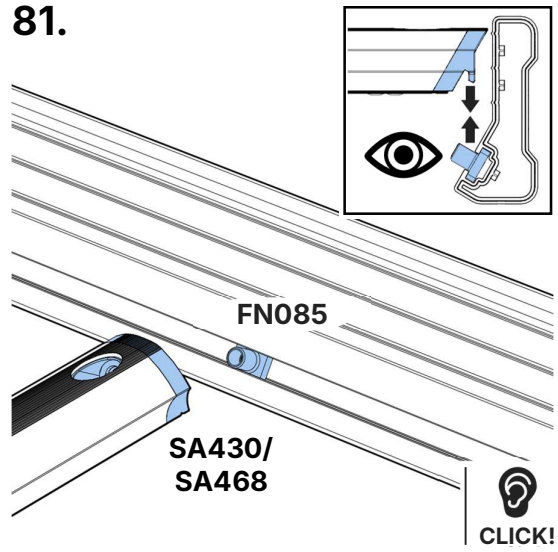

82.

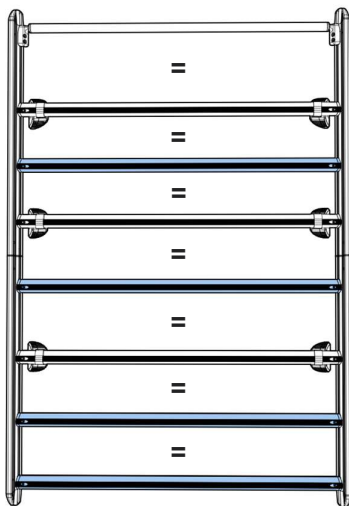

83.

